

## **DISHWASHER**

WSF67251

**Applicable to WSF67251 dishwashers with  
serial numbers greater than 82100000  
For previous models go to page 24**

## CONGRATULATIONS

Dear customer,

Congratulations on the purchase of your new Westinghouse dishwasher.

Before you use the dishwasher, we recommend that you read through the whole user manual which provides the description of the dishwasher and its functions.

To avoid the risks that are always present when you use an electrical appliance, it is important that the dishwasher is installed correctly and that you read the safety instructions carefully to avoid misuse and hazards.

We recommend that you keep this instruction booklet for future reference and pass it on to any future owners.

After unpacking the appliance, please check it is not damaged. If in doubt, do not use the appliance but contact your local Customer Care Centre.

For contact details, refer to the last page of this user manual.

### Conditions of use

This appliance is intended to be used in household and similar applications such as:

- Staff kitchen areas in shops, offices and other working environments
- Farm houses
- By clients in hotels, motels and other residential type environments
- Bed and breakfast type environments

**Please ensure you read the instruction manual fully before you call for service, or a full service fee could be applicable.**

Record model and serial number here:

Model number:.....

Serial number:.....

PNC:.....

### IMPORTANT INFORMATION THAT MAY IMPACT YOUR MANUFACTURER'S WARRANTY

Adherence to the directions for use in this manual is extremely important for health and safety. Failure to strictly adhere to the requirements in this manual may result in personal injury, property damage and affect your ability to make a claim under the Westinghouse manufacturer's warranty provided with your product. Products must be used, installed and operated in accordance with this manual. You may not be able to claim on the Westinghouse manufacturer's warranty in the event that your product fault is due to failure to adhere this manual.

## CONTENTS

General warnings.....	3
Safety instructions.....	4
Product description .....	5
Technical specifications .....	5
Control panel.....	6
Control description .....	7
Programs.....	8
Settings.....	9
Hints and tips.....	10
Installation .....	11
Preparing for use.....	14
Loading.....	16
Maintenance and cleaning .....	21
Troubleshooting.....	22
Warranty.....	23

Please read the user manual carefully and store in a handy place for later reference.

The symbols you will see in this booklet have these meanings:



### WARNING

This symbol indicates information concerning your personal safety.



### CAUTION

This symbol indicates information on how to avoid damaging the appliance.



### IMPORTANT

This symbol indicates tips and information about use of the appliance.



### ENVIRONMENT

This symbol indicates tips and information about economical and ecological use of the appliance.

## GENERAL WARNINGS

Please read the user manual carefully and store in a handy place for later reference. Pass the user manual on to possible new owners of the appliance.

Read the following carefully to avoid damage or injury.

**Note: You must read these warnings carefully before installing or using the appliance. If you need assistance, contact your Customer Care Department. The manufacturer will not accept liability, should these instructions or any other safety instructions incorporated in this book be ignored.**

### Children and vulnerable people safety.



#### WARNING

Risk of injury or permanent disability.

This appliance can be used by children aged from 8 years and above and persons with reduced physical, sensory or mental capabilities or lack of experience and knowledge if they have been given supervision or instruction concerning use of the appliance in a safe way and understand the hazards involved.

- Do not let children play with the appliance.
- Keep all detergents away from children.
- Keep children and pets away from the appliance door when it is open.
- Cleaning and user maintenance shall not be made by children without supervision.



#### WARNING

It is important to use your appliance safely. Check these safety points before using your appliance.

### General Safety

- Do not change the specification of this appliance.
- The operating water pressure (minimum and maximum) must be between 0.5 (50) / 8 (800) bar (kPa)
- Obey the maximum number of 15 place settings.
- If the supply cord is damaged, it must be replaced by the manufacturer, its Authorised Service Centre or similarly qualified persons in order to avoid a hazard.
- Put knives and cutlery with sharp points in the cutlery basket with the points down or in a horizontal position.
- Do not leave the appliance door open without supervision to prevent causing a trip hazard.
- Before maintenance, turn the appliance off and disconnect the plug from the mains.
- Do not use water spray and steam to clean the appliance.
- The appliance is to be connected to the water mains using the new supplied hose-sets. Old hose sets must not be reused.
- The ventilation openings in the base (if applicable) must not be obstructed.
- Some dishwasher detergents are strongly alkaline. They can be extremely dangerous if swallowed. Avoid contact with the skin and eyes and keep children away from the dishwasher when the door is open.
- Check that the detergent receptacle is empty after completion of the wash cycle.

### Installation

- Remove all the packaging.
- Do not install or use a damaged appliance.
- Do not install or use the appliance where the temperature is less than 0°C.
- Obey the installation instruction supplied with the appliance.
- Make sure that the appliance is installed below and adjacent to safe structures.

## SAFETY INSTRUCTIONS



### WARNING

Risk of fire and electrical shock.

#### Electrical connection

- The appliance must be earthed.
- Make sure that the electrical information on the rating plate is the same as the power supply. If not, contact an electrician.
- Always use a correctly installed shockproof socket.
- Do not use multi-plug adapters and extension cables.
- Make sure not to cause damage to the mains plug and to the mains cable. Should the mains cable need to be replaced, this must be carried out by our Authorised Service Centre.
- Connect the mains plug to the mains socket only at the end of the installation. Make sure that there is access to the mains plug after the installation.
- Do not pull the mains cable to disconnect the appliance. Always pull the mains plug.

#### Water connection

- Make sure not to cause damage to the water hoses.
- Before you connect the appliance to new pipes or pipes not used for a long time, let the water flow until it is clean.
- The first time you use the appliance, make sure that there is no leakage.
- The water inlet hose has a safety valve and a sheath with an inner mains cable.

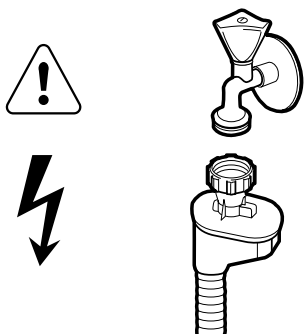

### WARNING

Dangerous voltage

- If the water inlet hose is damaged, immediately disconnect the mains plug from the mains socket. Contact the Authorised Service Centre to replace the water inlet hose.

#### Use

- Do not sit or stand on the open door.
- Dishwasher detergents are dangerous. Obey the safety instructions on the detergent packaging.
- Do not drink and play with the water in the appliance.
- Do not remove the dishes from the appliance until the program is completed. There can be detergent on the dishes.
- The appliance can release hot steam if you open the door while a program operates.
- Do not put flammable products or items that are wet with flammable products in, near or on the appliance.



### WARNING

Risk of injury or suffocation.

#### Disposal

- Disconnect the appliance from the mains supply.
- Cut off the mains cable and discard it.
- Remove the door catch to prevent children and pets to get closed in the appliance.

## PRODUCT DESCRIPTION

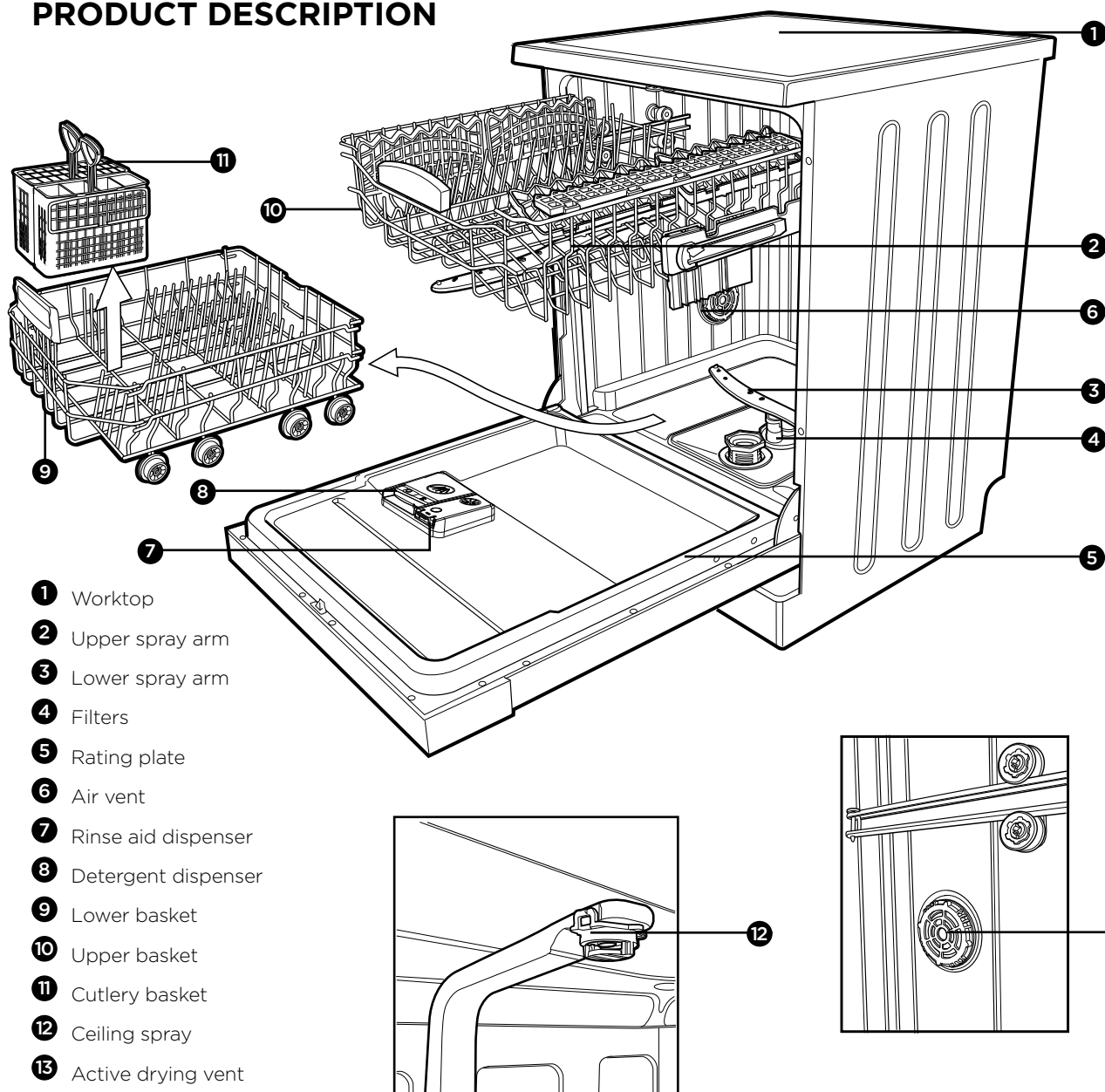

## TECHNICAL SPECIFICATIONS

MODEL	WSF67251 - freestanding
Capacity	15 place settings
Height	850mm
Height (without worktop)	820mm
Width	598mm
Depth	598mm
Net weight	54kg
Electricity input	220-240 V, 50 Hz
Current	10 A
Total power	1900W
Water supply pressure	max. 1MPa min. 0.03MPa
Water supply	hot or cold water max. 60°C 10L/min

## CONTROL PANEL

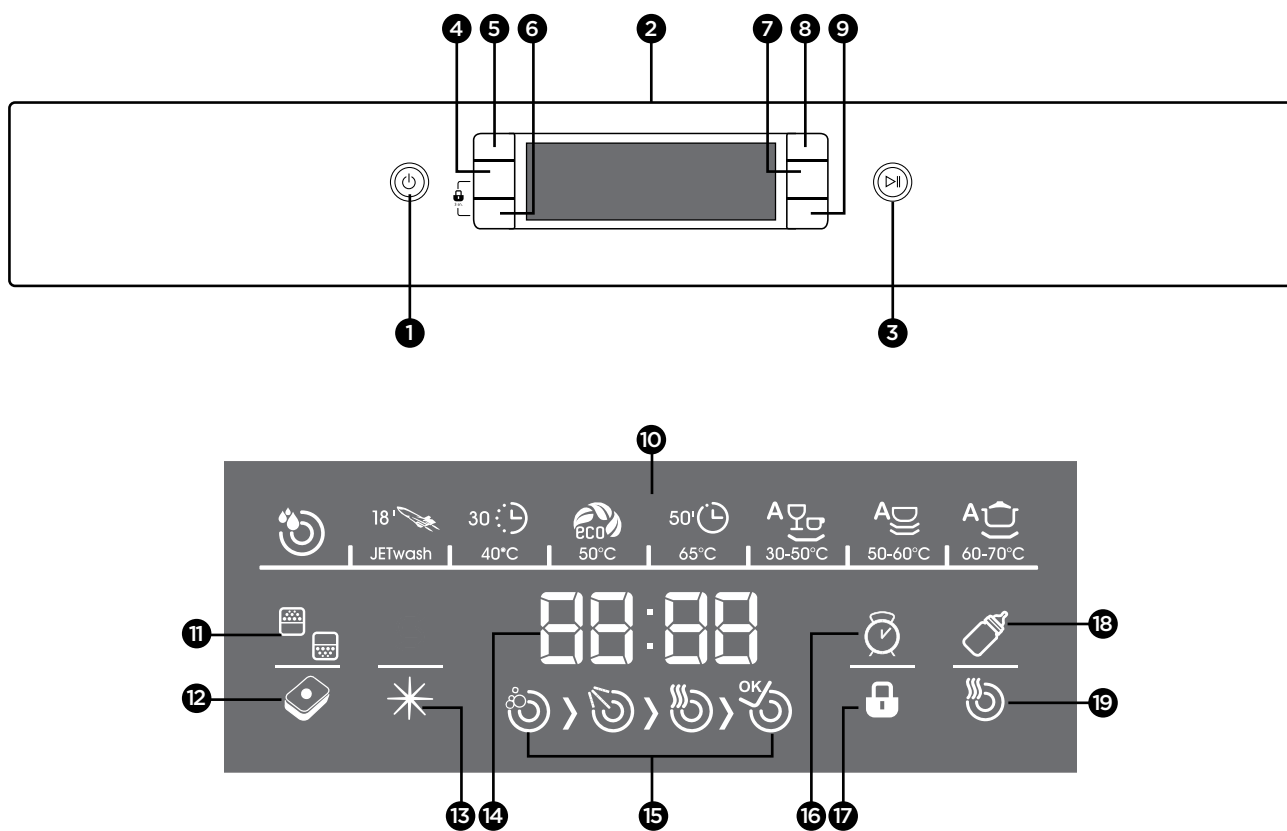

- |                               |                                    |
|-------------------------------|------------------------------------|
| 1 On/off button               | 13 Rinse aid level warning display |
| 2 Door handle                 | 14 Remaining time/delay            |
| 3 Start/standby button        | 15 Progress indicator              |
| 4 FlexZone button             | • Washing phase                    |
| 5 Program button              | • Rinsing phase                    |
| 6 Tablet detergent button     | • Drying phase                     |
| 7 Hygiene button              | • End indicator                    |
| 8 Delay button                | 16 Delay indicator                 |
| 9 Dry Plus button             | 17 Child Lock indicator            |
| 10 Program displays           | 18 Hygiene indicator               |
| 11 FlexZone indicator         | 19 Dry Plus indicator              |
| 12 Tablet detergent indicator |                                    |

# CONTROL DESCRIPTIONS

## Power on/off button ①

When you press the on/off button, the machine is switched on and the display shows the Eco 50 program, the dishwasher is off when the LEDs on the display are off.

## Door handle ②



Use the door handle to open/close the door of your dishwasher.

## Start/Standby button ③

When the start/standby button is pressed, the program selected with the program button will start and the progress indicator display will show the washing image  ⑬. The progress indicator display will show the washing phases. ⑮

## FlexZone button ④

The FlexZone function allows dishes to be washed in the upper basket only, lower basket only or both upper and lower baskets to cater for every load size.

If you do not have a full load of dishes in your machine you can also activate the FlexZone function for some programs.   If you have dishes in both baskets, press the FlexZone button and select the position in which both lamps are highlighted.

 If you have dishes only in the upper basket, press the FlexZone button and select the position in which the upper image is illuminated. Thus, washing up shall be done only on the upper basket of your machine.

 If you have dishes only in the lower basket, press the  $\frac{1}{2}$  key and select the position in which the lower image is illuminated. Thus, washing up shall be done only on the lower basket of your machine. When using this feature, make sure that there are no dishes in the upper basket.

## Program button ⑤

Select the appropriate washing program from the display using the program button. ⑩

## Tablet detergent button ⑥

Press the tablet detergent button whenever using tablets. If this button is active for the program you have selected, indicator ⑫ will be illuminated on the display.

## Dry Plus button ⑨

Using this button, you may add extra drying to the program you have selected.

When you select the extra drying function, indicator ⑰ is illuminated on the display. Using this function, you may add more drying steps to the program you have selected and consequently obtain drier dishes.

## Delay button ⑧

Once a program is selected and before the program starts, you may adjust the delay time by pressing the delay button. The program start can be delayed from 1-24 hours. When you press the delay button, indicator ⑮ will be illuminated on the display.

## Hygiene button ⑦

Select this button to obtain extra hygiene, this will alter the water temperature and washing time of the program you have selected. When you select the hygiene function, indicator ⑱ will be illuminated on the display.

## Rinse aid level warning display ⑬

In order to understand whether the rinse agent in your machine is sufficient or not, please check the rinse agent level warning display. If this display is illuminated, fill the rinse agent section.







## Remaining time delay display ⑭

The remaining time display shows the duration of the programs and the remaining time while the program is in operation. If you have selected a delay time, the display will count down the delay time and then the program time.

## Use of child lock

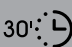
In order to activate the child lock, press both "tablet detergent" and "FlexZone" buttons at the same time for 3 seconds. In the meantime, you will see "CL" for 2 seconds on the Remaining time display. In order to deactivate, press both "tablet" and "FlexZone" buttons at the same time for 3 seconds. "CL" will flash two times.

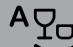
## PROGRAMS

DISPLAY SYMBOL								
PROGRAM	PREWASH	QUICK 14 MINS	FAST 30 MINS 40°C	ECO 50°C	TIMESAVE 50 MINS	AUTO	AUTO	AUTO
WASHING TEMP	35°C		40°C	***50°C	65°C	30-50°C	50-60°C	60-70°C
FOOD RESIDUE TYPE	Fresh light contamination, coffee, milk, tea	Fresh light contamination, coffee, milk, tea	Fresh light contamination, coffee, milk, tea, cold meat, vegetables	Fresh light contamination, coffee, milk, tea, cold meat, vegetables	Old soups, sauces, pastries, egg, rice potato and oven foods, fried foods	Old soups, sauces, pastries, egg, rice potato and oven foods, fried foods		
SOIL LEVEL	Low	Low	Low	Normal	Medium	High	High	High
DETERGENT AMOUNT B: 25CM <sup>3</sup> /15CM <sup>3</sup> A: 5CM <sup>3</sup>	-	**A	B	A+B	A+B	A+B	A+B	A+B
PROGRAM DURATION (MINUTES)	15	14	30	155	50	64-92	100-121	111-179
POWER CONSUMPTION	0.02	0.34	0.76	0.79	1.29	0.80-0.99	1.13-1.46	1.30-1.95
WATER CONSUMPTION	4.2	6.6	10.9	13.5	10.7	10.6-17.7	10.9-18.5	12.3-24.6
VALUES WHEN FLEX ZONE FEATURE IS USED								
PROGRAM DURATION (MINUTES)	15	14	30	148	46	62-80	82-101	123-159
POWER CONSUMPTION	0.02	0.34	0.76	0.75	1.25	0.77-0.96	1.10-1.43	1.10-1.43
WATER CONSUMPTION	4.2	6.6	10.9	13.5	10.7	9.9-13.7	10.5-14.3	11.9-19.9

\* The Quick 14 minute program can be used for lightly soiled dishes and suitable for washing 4 place settings.

\*\* The Quick 14 minute program should use only powder detergent.

\*\*\* With this program you have the most efficient use of water and energy consumption for crockery and cutlery for normal soil. (This is the standard program for Test Institutes).

### Information for test institutes

For all the necessary information for test performance; send an email to [dishwasher@standardtest.info](mailto:dishwasher@standardtest.info) and provide the model and PNC number on the rating plate.



### CAUTION

The Quick 14 minute, Fast 30 minute and TimeSave 50 minute programs do not have a drying step.

The values stated above are values that are obtained in laboratory environment relative to related standards.

These values can change according to the product's usage and environment (mains voltage, water pressure, water inlet temperature and ambient temperature).



## SETTINGS

### Starting the machine

1. Press on/off switch. **1**
2. Select the appropriate program for your dishes using the program button. **5**
3. If you prefer, you can select additional functions. **4 6 7 9**
4. Start the program by pressing the start/standby button. **3**

### Program follow-up

You can follow the progress by the help of the program follow-up symbols on the display. **15**

As the washing proceeds, respective washing and rinsing symbols will be illuminated.  

When the drying symbol is on, the machine remains silent for about 45-50 minutes. 

Do not open the door before the end indicator is illuminated. When the program finishes, end indicator is illuminated. 

When the program you have selected starts, you may see the estimated remaining time in the time indicator display.



*NOTE: The total time that programs take can differ according to ambient temperature, the temperature of the mains water and the amount of dishes; therefore the program may take a different amount of time than that initially stated.*

### Program follow-up

Once the selected program starts, should you wish to change to a different program;

- Press on start/standby button. **3**
- Select the new program using program button. **5**
- The newly selected program continues from where the previous one was left.
- Start the program by pressing the start/standby button again. **3**

### Cancelling program

If you want to cancel the program once it has started;

- Hold the start/standby button for 3 seconds. **3**
- The display will count down from 3 to 1 and when the countdown is over, the remaining time will be displayed as 1 minute.

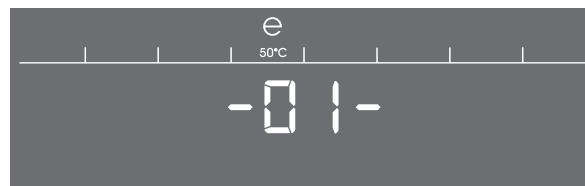
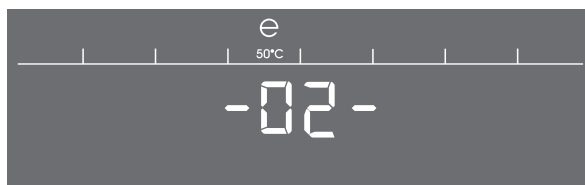
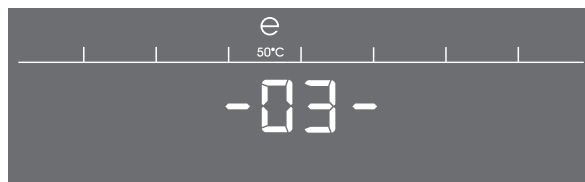

The machine will empty all the water in this 1 minute; the time is reset and completion symbol is illuminated.

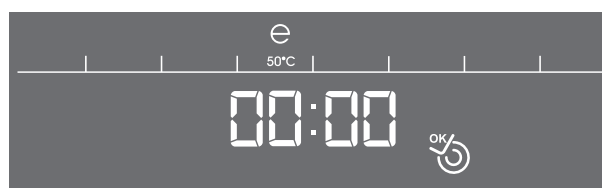
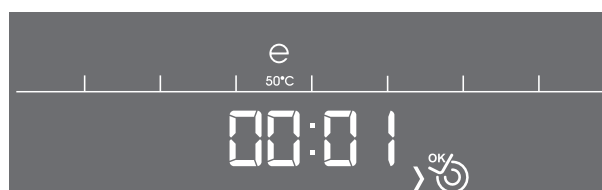

### Switching off the dishwasher

- When the end indicator is illuminated, switch off your machine by pressing the on/off button.
- Later, unplug your machine and turn off its faucet.

*NOTE: To improve drying results with the most efficient use of energy, open the door approximately 10cm when the program is finished and the end indicator is illuminated. Leave door ajar and allow the dishes to cool for 30-40mins.*

*If the machine door is opened or a power failure occurs during washing, the machine will resume the cycle where it stopped when the door is closed or power is restored.*

## HINTS AND TIPS

### If one of program monitor lights is on and start/pause light is flashing

- Your machine's door is open, shut the door to continue.

### If the program won't start

- Check if the plug is connected.
- Check your indoor fuses.
- Check that the water inlet tap is turned on.
- Check that you have closed the machine door.
- Check that you switched off the machine by pressing the power on/off button.
- Check that the water inlet filter and the machine filters are not clogged.

### If the control light is off after a wash operation

- The power on/off button isn't released yet.

### If detergent residues are left in the detergent compartment

- Detergent has been added when the detergent compartment was wet.
- Large dishes have blocked the dispenser door.

### If water is left inside the machine at the end of the program

- The water drain hose is clogged or twisted.
- The filters are clogged.
- The program is not finished yet.



### IMPORTANT

At the end of the program, water may still remain on the sides and door of the appliance.

### If the machine stops during a wash operation

- Power failure.
- Water inlet failure.
- Program is on standby mode.

### If shaking and hitting noises are heard during a wash operation

- Dishes are placed incorrectly.
- The spray arm is hitting the dishes.

### If there are partial food wastes left on the dishes

- Dishes are placed incorrectly into the machine, sprayed water did not reach related places.
- Basket overloaded.
- Dishes leaning against one another.
- Very small amount of detergent added.
- An unsuitable, rather weak wash program selected.
- Spray arm clogged with food waste.
- Filters clogged.
- Filters incorrectly fitted.
- Water drain pump clogged.

### If there are white stains on the dishes

- A very small amount of detergent is being used.
- Rinse aid dosage setting at a very low level.
- Water hardness is very high.

### If the dishes won't dry

- A program without a dry operation selected.
- Rinse aid dosage set too low.
- Dishes unloaded too fast.
- Use a hotter program

### If there is rust on the dishes

- Stainless-steel quality of the dishes washed is insufficient.
- High level of salt in the wash water.
- Unhealthy mains grounding.

### Unloading the baskets

- For improved drying results with the most effective use of energy, open the door approximately 10cm at the end of the program.
- Allow the tableware to cool for 30-40 minutes as hot items can easily be damaged.
- First remove items from the lower basket before removing the items from the upper basket.

### Call an authorised service if the problem still persists after the controls or in case of any malfunction not described above.

### Useful Information

- Whenever you will not be operating your machine:
  - Unplug the machine and then turn water off.
  - Leave the door slightly ajar in order to prevent the formation of unpleasant smells.
- Keep the machine interior clean.
- Correct loading of dishes in the machine, enables reduced energy consumption and improved washing and drying performance.
- Remove all large food remnants before you placing dirty dishes into the machine.
- Operate the machine after it is completely full.
- If the appliance is located in a place where the risk of freezing exists, you must completely drain the water that has remained in the machine. Turn off the water tap, disconnected the water inlet hose from the tap and allow the interior water to drain.

# INSTALLATION

## General

- When determining where to put your machine, choose a place where you can easily load and unload your dishes.
- Do not put your machine in any location where there is a probability for the room temperature to fall below 0°C.
- Before positioning, take the machine out of its packaging by following the warnings located on the package.
- Position the machine close to a water tap or drain. You need to site your machine, taking into consideration that its connections will not be altered once they are made.
- Do not grip the machine by the door in order to move it.
- Leave a clearance on all sides of the machine so that you can comfortably move it back and forth during cleaning.
- Make sure that the water inlet and outlet hoses aren't squeezed while positioning the machine. Also, make sure that the machine does not stand on the electrical cable.
- Adjust the machine's adjustable feet so that it can stand level and balanced. Proper positioning of the machine ensures problem-free opening and closing of the door.
- If the door of your machine does not close properly, check if the machine is stable on the floor it stands; if not, adjust the feet and ensure its stable position.

## Water connection

Connect the inlet hose to a water tap with an external BSP thread spout of 3/4".

For best washing performance it is recommended to connect the appliance to a cold water supply.

Energy savings can be made by connecting the appliance to a solar water system and using economy options, however the water temperature must not exceed 60°C

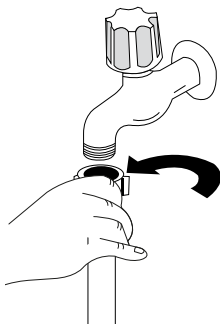

### CAUTION

**Only turn the locking nut to secure the hose. Do not turn the hose.**

## Inlet water supply

- Water pressure: 800kPa max – 50 kPa min.
- Water flow rate 10 L/minute
- If water pressure is in excess of 800 k Pa, a pressure reducing valve should be used. Check for leaks.
- If water temperature is in excess of 60°C, a tempering valve should be used. Check for leaks.



### CAUTION

Always use new hoses when you connect the appliance to the water mains. Old hoses must not be used. The water inlet hose must be examined at an interval of twelve months for deterioration and replaced if necessary.

In order to pass the safety valve through the kitchen cabinets, an opening of at least 45mm x 90mm is needed.

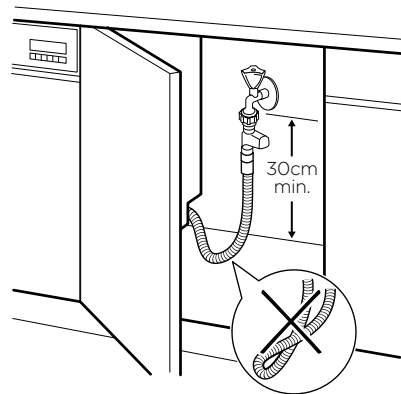

## Water drain hose

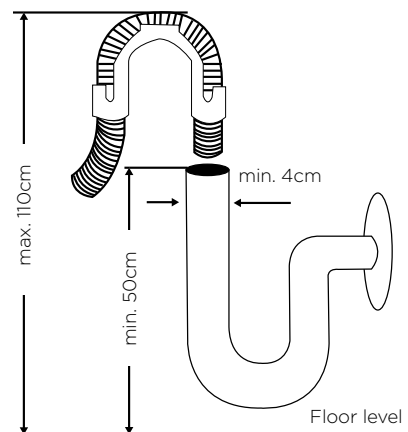

The water drain hose can be connected either directly to the water drain hole or to the sink outlet spigot. Using a special bent pipe (if available), the water can be drained directly into the sink via hooking the bent pipe over the edge of the sink. This connection should be at a minimum of 50cm and at a maximum of 110cm from the floor.



### CAUTION

When a drain hose longer than 4m is used, the dishes won't be cleaned properly and might remain dirty.

## INSTALLATION

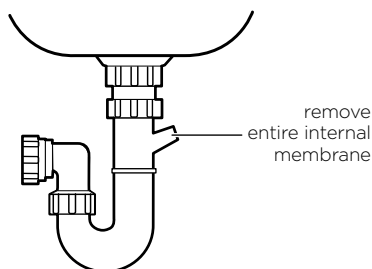

Correct

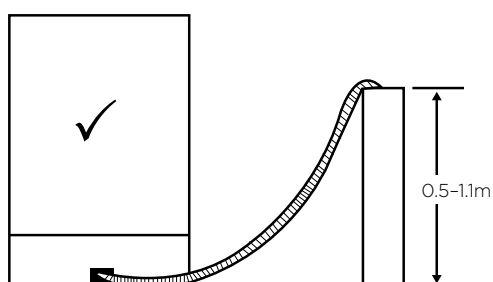

Incorrect

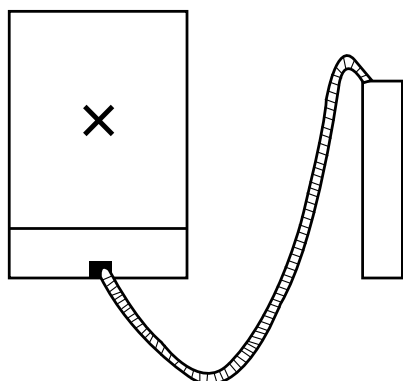

### Installing a freestanding dishwasher

If the under counter height is greater than 850mm, the dishwasher can be installed without removing the worktop.

If the under counter space is less than 850mm but greater than 820mm the worktop will need to be removed.

To remove the worktop, remove the screws located at the rear of the machine, then, from the front, push the worktop towards the rear and lift.

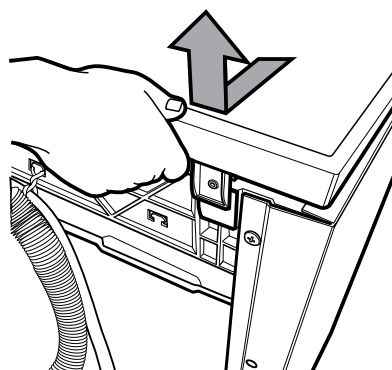
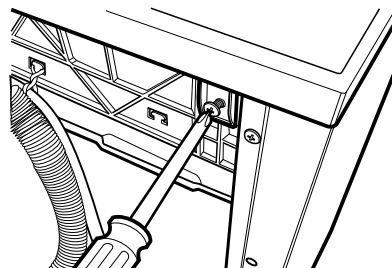

To ensure stability of the dishwasher in an undercounter installation, any gap between the dishwasher and the underside of the countertop should be bridged with a packing piece. This may be achieved by wedging a piece of timber between the dishwasher and the underside of the countertop.

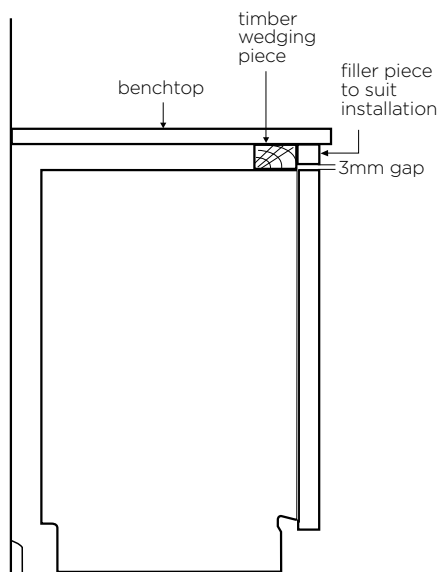

## INSTALLATION

In some cases you may need to remove the top concrete counterweight and trim the felt with a knife. To remove the counterweight, follow the steps below.

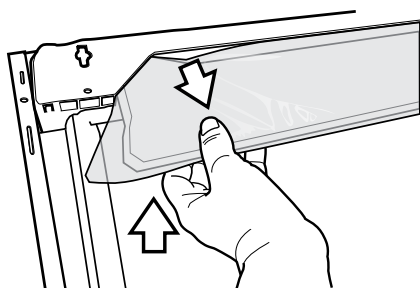
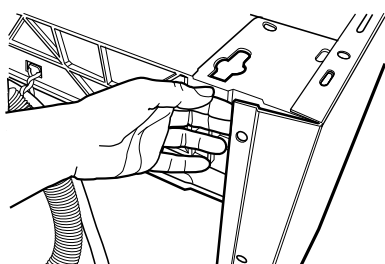
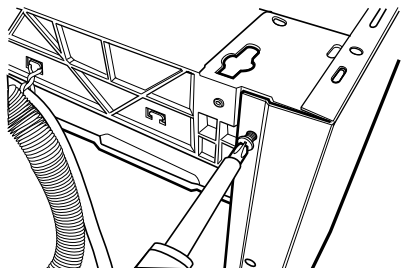

### CAUTION

If the counterweight has been removed, the dishwasher must be stabilised by wedging a piece of timber between the dishwasher and the underside of the countertop.

To remove the felt and the dishwasher support blocks: Lift and cut felt.

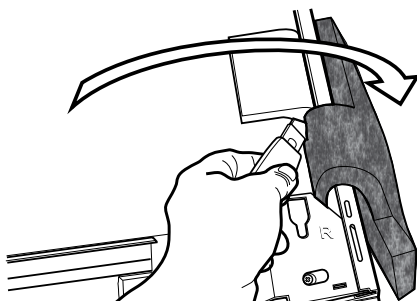

Remove 2 blocks of foam as shown.

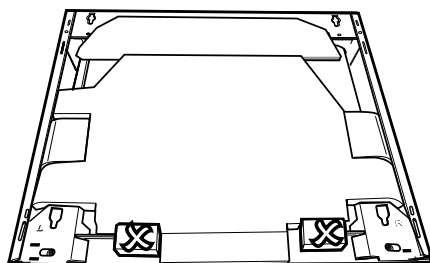

## Finishing the installation

1. Fit the steam protection tape to the underside of the countertop.

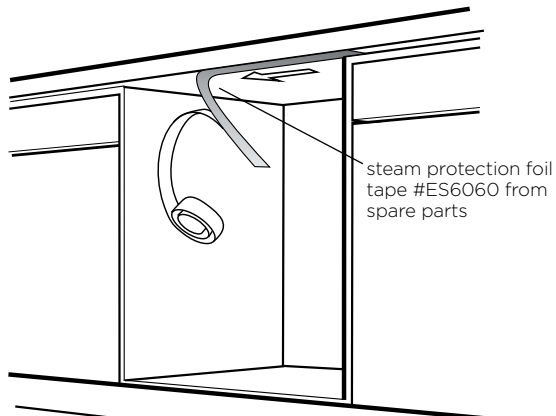

2. Adjust the dishwasher feet according to the slope of the floor then carefully slide the dishwasher into the cavity.

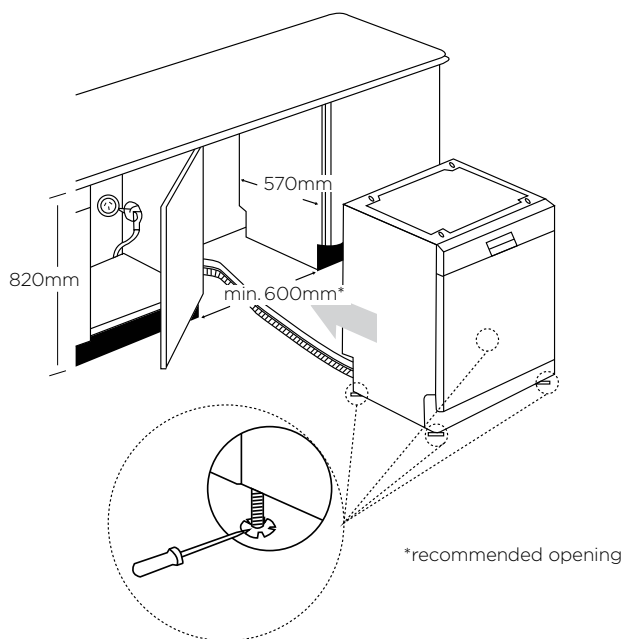

\*recommended opening



### CAUTION

When installing the dishwasher into the cavity, take care not to crush or kink the hoses or electrical cable.

## PREPARING FOR USE

### Detergent usage

Use a detergent specifically designed for use in domestic dishwashers. You can find powder, gel and tablet detergents in the market that have been designed for household dishwashers. Detergent should be put into the compartment prior to starting the machine. Keep your detergents in cool, dry places out of reach of children. Do not fill detergent into the detergent compartment more than required; otherwise it may cause scratches on your glasses as well as lead to a poorly dissolved detergent. Should you need more information concerning the detergent you will use, contact detergent manufacturers directly.

### Filling the detergent compartment

Push the latch to open the detergent container as shown in the image.

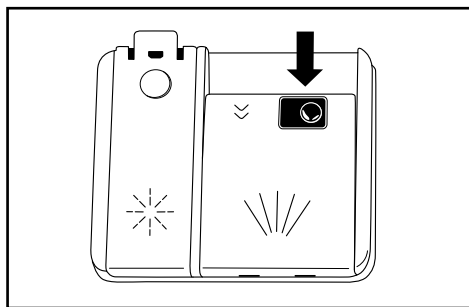

The Detergent pod has level lines inside. It is possible to measure the right detergent amount using these lines.

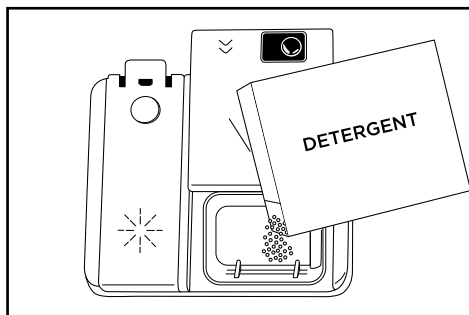

The detergent pod can take a maximum of 40cm<sup>3</sup> detergent.

Open the dishwasher detergent pod and pour 25cm<sup>3</sup> if your dishes are heavily soiled or 15cm<sup>3</sup> if they are less soiled.

You may have to add more detergent into your machine, depending on the degree of soil and the water hardness in your area.

If your dishes are from the previous day and there is dried food waste on them, or if you have fully loaded the dishwasher, pour 5cm<sup>3</sup> detergent onto the base of the door and start your machine.

### Combined detergent

Detergent manufacturers also produce combined detergents called "2 in 1", "3 in 1" or "5 in 1" etc. "2 in 1" detergents contain detergent + rinse aid. When using "2 in 1" detergents make sure to check the specifications of the tablet.

Other tablet detergents contain detergent + rinse aid + various extra functions.

Generally, combined detergents produce suitable results under certain usage conditions only.

These detergents contain rinse aid and/or other additives in preset amounts.

### Points to consider when using these type of products:

- Always make sure to check the specifications of the product you will use or whether or not it is a combined product.
- Check if the detergent used is appropriate for the hardness of mains water that machine relates to.
- Observe the instructions on packaging when using such products.
- If such detergents are in the form of tablets, never put them into the interior section or the cutlery basket of the dishwasher. Always put the tablets into the detergent compartment in the detergent dispenser.
- They produce good results for certain types of usage only. If you are using this type of detergent, you need to contact the manufacturers and find out about the suitable conditions of use.
- When the conditions of use of such products and the machine settings are appropriate, they ensure savings in salt and/or rinse aid consumption.
- Contact the detergent manufacturer if you are not obtaining good wash results (if your dishes stay calcareous and wet) after having used 2 in 1 or 3 in 1 detergents. The scope of warranty for your machine does not cover any complaints caused by the use of these types of detergents.

### Recommended usage:

For better results while using combined detergents, add rinse aid to your machine and adjust the rinse aid setting to the lowest position.

## PREPARING FOR USE

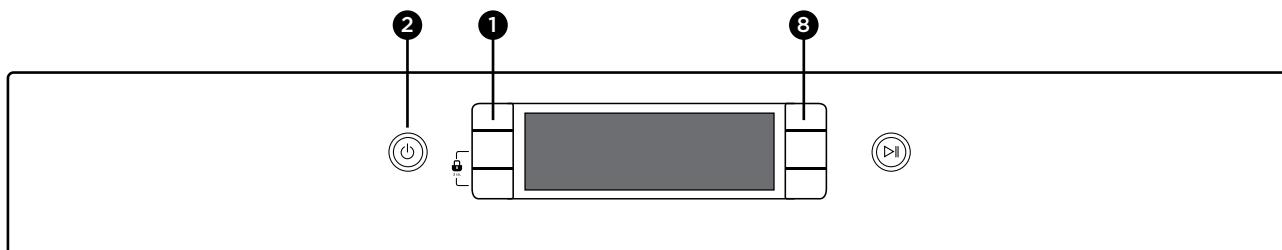

### CAUTION

Solubility of the tablet detergents produced by different companies can vary depending on the temperature and time. Therefore, it is not recommended to use such detergents in short programs. It is more suitable to use powder detergents in such programs.

Should any problem, which you have not encountered before, arise with the use of this type of detergents, contact the detergent manufacturers directly.

#### When you give up using combined detergents

- Fill the rinse aid compartment.
- Set the suitable rinse aid setting.

#### Filling with rinse aid and setting

To fill the rinse aid compartment, open the rinse-aid compartment cap.

Fill the compartment with rinse aid until MAX level and then close the cap.

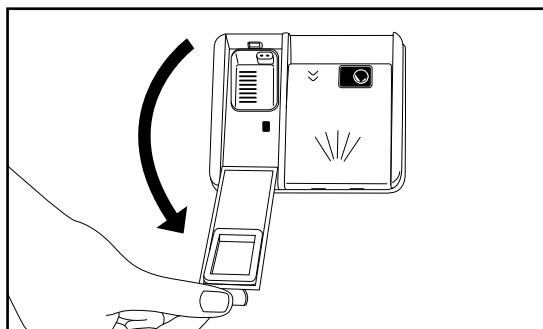
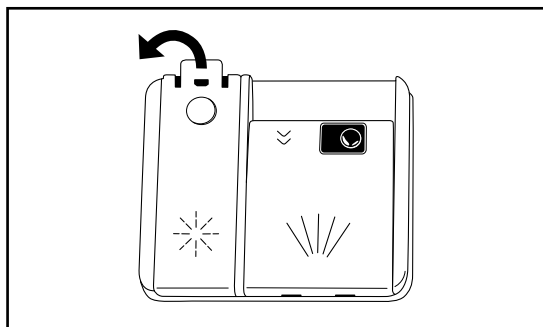

Be careful not to overfill the rinse aid compartment and wipe up any spills.

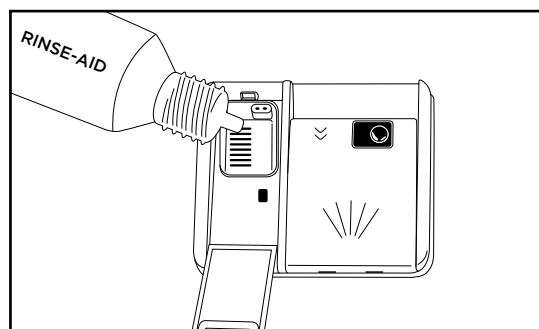

#### In order to set rinse aid level, follow below steps:

Push the program button (button 1 on diagram above) and hold it down.

Turn on the machine (button 2).

Hold down the program button (1) until "rA" disappears from the display.

The machine will display the last setting.

Set the level by pushing buttons (1) and (8).

Switch off the machine to save the setting.

The factory setting is "r:04".

If the dishes are not drying properly or are spotted, increase the rinse-aid level. If blue stains form on your dishes, decrease the rinse-aid level.

Level	Rinse-aid dose	Indicator
1	0	r:01
2	1.5mL	r:02
3	3mL	r:03
4	4.5mL	r:04
5	6mL	r:05

### CAUTION

Use only those rinse aid materials which are allowed for use in the machine. As rinse aid residues left as a result of overflowing will create extremely high amounts of foam and thus reduce the washing performance, remove the excess amount of rinse aid by wiping it with a paper towel or cloth.

## LOADING YOUR DISHWASHER

If your dishes are correctly placed in the dishwasher, you will be using it in the best way in terms of energy consumption, washing and drying performance.

There are two separate baskets for you to load your dishes into your machine. You can load into the lower basket such round and deep items as pots with long handles, pot lids, plates, salad plates, cutlery sets.

The upper basket has been designed for tea plates, dessert plates, salad bowls, cups and glasses. When placing long-stem glasses and goblets, lean them against the basket edge, rack or glass supporter wire and not against other items. Do not lean long glasses against one another or they won't remain steady and can be damaged.

It is recommended that thin narrow items be placed into the middle sections of baskets. You can place spoons among the other cutlery sets in order to prevent them from sticking to one another, use the cutlery grid in order to obtain the best result.

To avoid any possible injuries, always place long-handle and sharp-pointed dishes such as serving fork or bread knife with their sharp points facing down or horizontally on the baskets.



### CAUTION

Place your dishes into your machine in a way that they will not prevent the upper and lower spray arms from spinning.

### Top basket cup rack

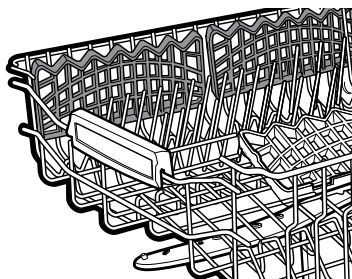

### Height Adjustable Rack

These racks are designed to increase the capacity of the top basket. You can place your glasses and cups on the racks. You can adjust the height of these racks. Thanks to this feature, you can place different sizes of glasses under these racks.

Thanks to height adjustment plastics mounted on the basket, you can use your racks in two different heights. In addition, you can place long forks, knives and spoons on these racks laterally, so that they do not block the revolution of propeller.

### Top basket height adjustment while full

Basket height adjustment mechanism on the top basket of your machine is designed to let you adjust the height of your top basket (refer to diagram ①) upwards or (refer to diagram ②) downwards, without removing it from your machine when it is full, and create large spaces at the top or bottom area of your machine as needed. Basket of your machine is set to upper position in factory settings.

In order to raise your basket, hold it from both sides and pull it upwards. In order to lower it, hold it from both sides again, pull upwards and lower carefully.

Make sure that both sides are in the same position (up or down).

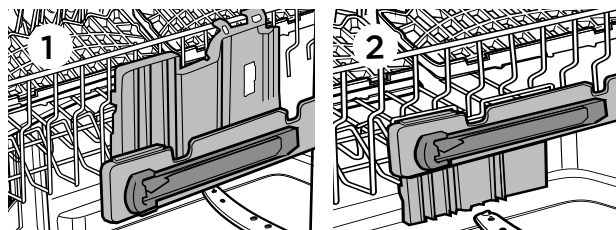
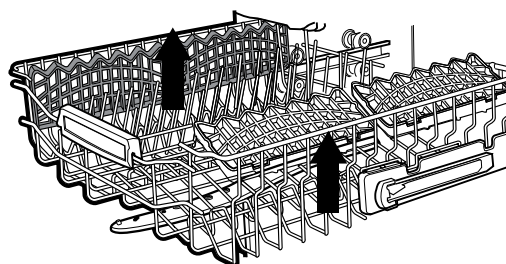



# LOADING YOUR DISHWASHER

## Spoon rack/Glass support

It allows your long-stemmed glasses to be washed safely as well as providing a convenient alternative location to wash spoons and forks. Do not lean your long-stemmed goblets and glasses against each other but towards the spoon rack, so that during the washing cycle this prevents glasses and goblets from being damaged.

There are 4 different positions for your spoon rack. Depending on the type of long stemmed glasses, you can set your spoon rack to the positions number 1 and 2.

Use it for your spoons and forks while it was in position 1.

If you do not want to use the spoon rack positions 3 or 4 are available.

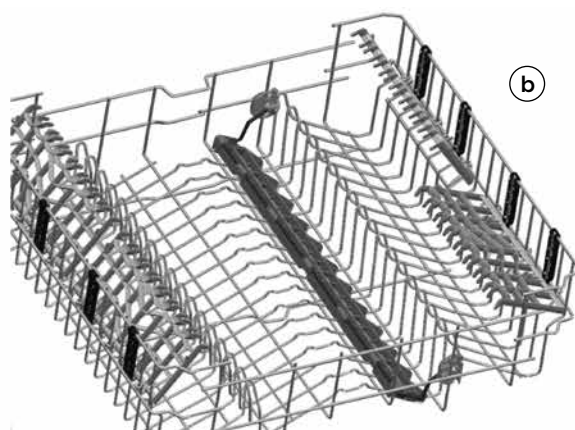
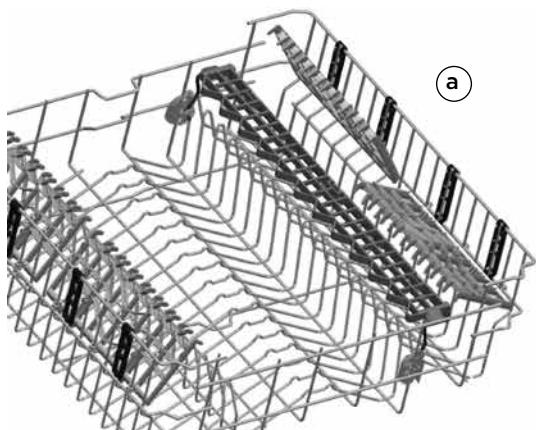
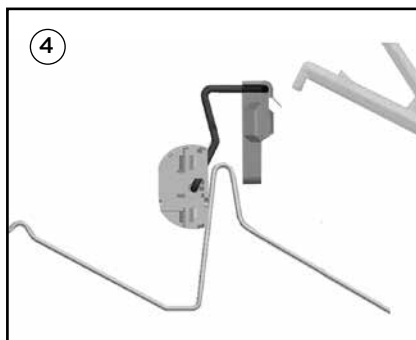
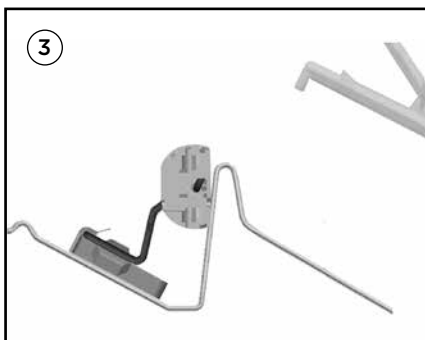
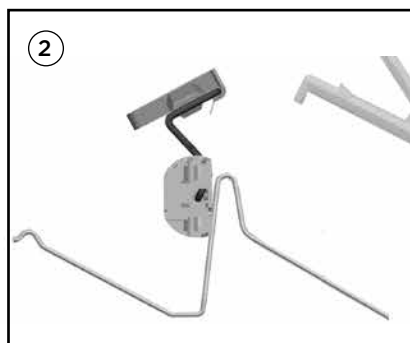
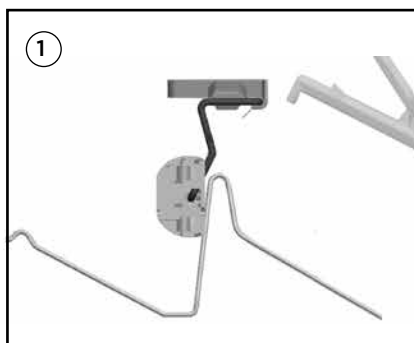
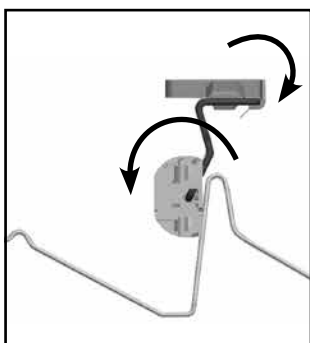
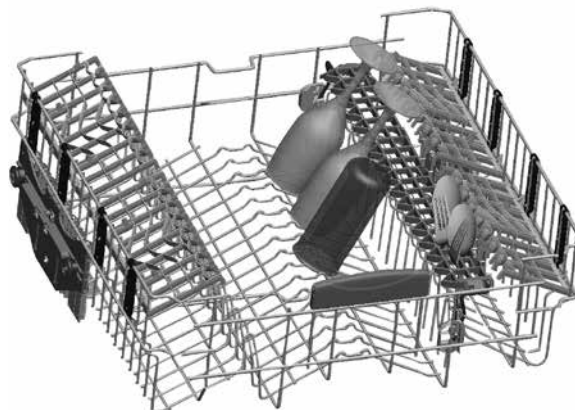

## LOADING YOUR DISHWASHER

### Lower Basket Folding Racks

Folding tines (prongs) consisting of four parts that are located on the lower basket of your machine are designed in order to let you place big items easier such as pots, pans, etc. If required, each rack can be folded separately, or all of them can be folded and larger spaces created. You can use folding tines (prongs) in the upright position, or by folding.

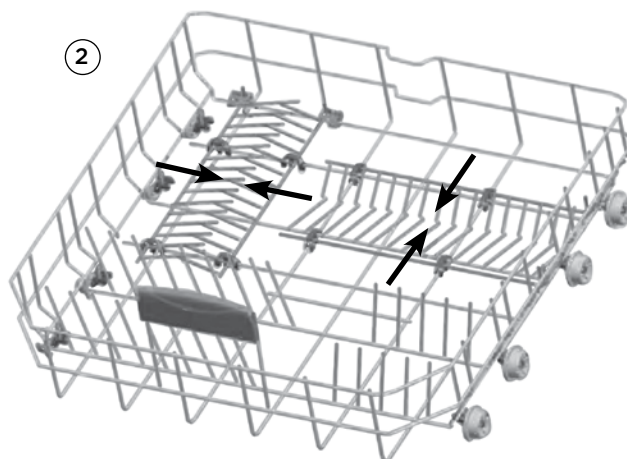
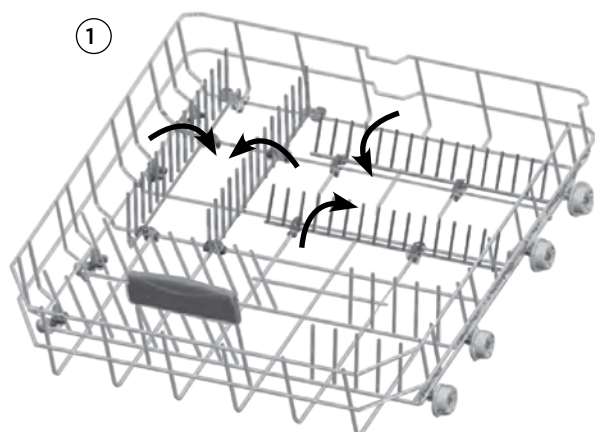

### Modular cutlery basket

Depending upon the amount of soiled cutlery, the basket can be separated into two parts. Hold the basket from both sides and move each side in opposite directions. To combine the baskets reverse the procedure.

The cutlery basket handles are adjustable, position (a) or (b). When separated, the baskets can be used in the upper or lower dishwasher basket as required.

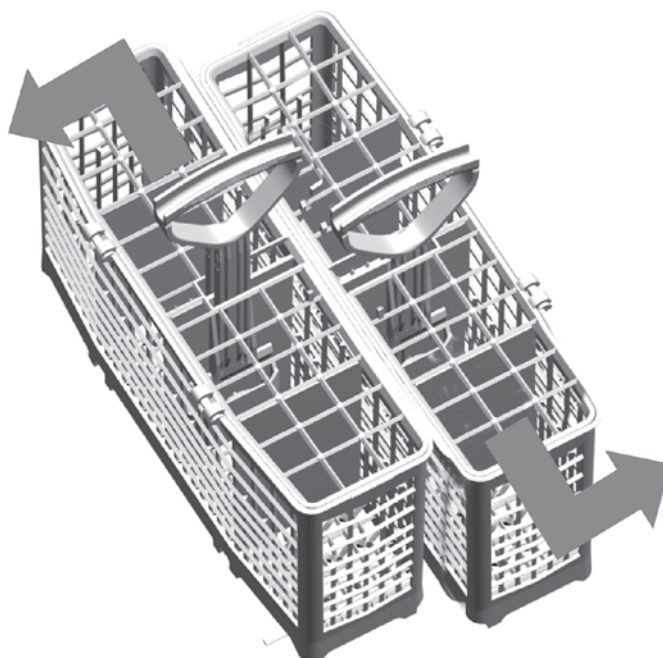
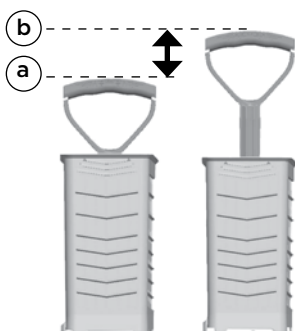

## LOADING YOUR DISHWASHER

### Alternative cutlery basket positions

The cutlery basket handle is adjustable - position (a) or (b). The basket can be used in the upper or lower dishwasher basket as required.

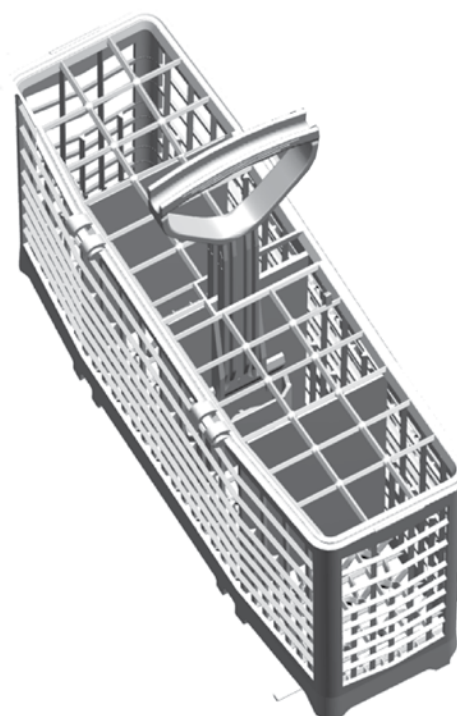
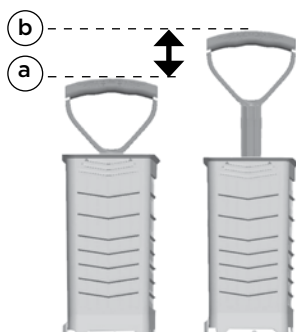

By placing your modular cutlery basket in different places of the upper or lower basket, you can create suitable locations for your other dishes.

Below you can see several recommended options.

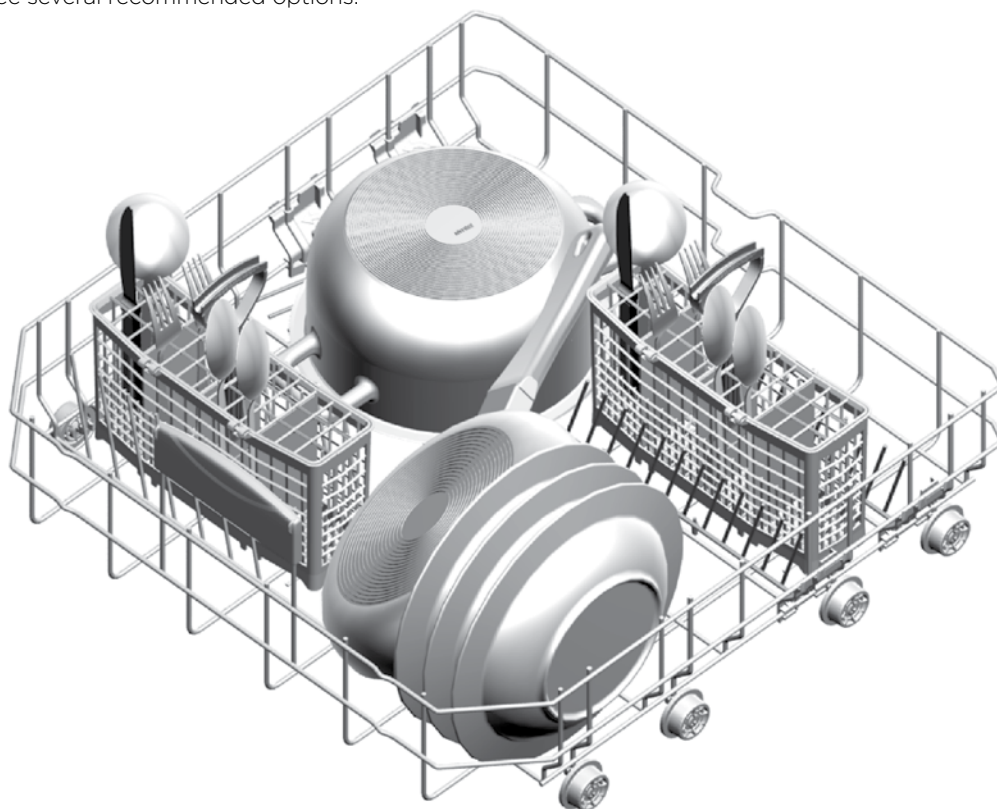

## LOADING YOUR DISHWASHER

### Alternative modular basket position

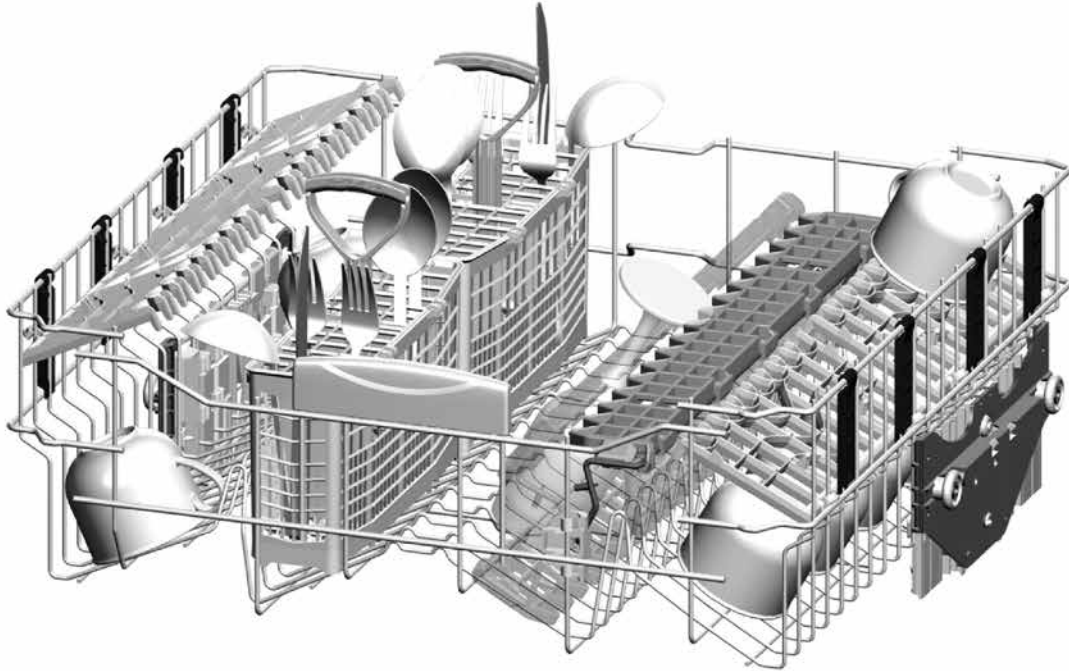

### Alternative basket loads Lower Basket

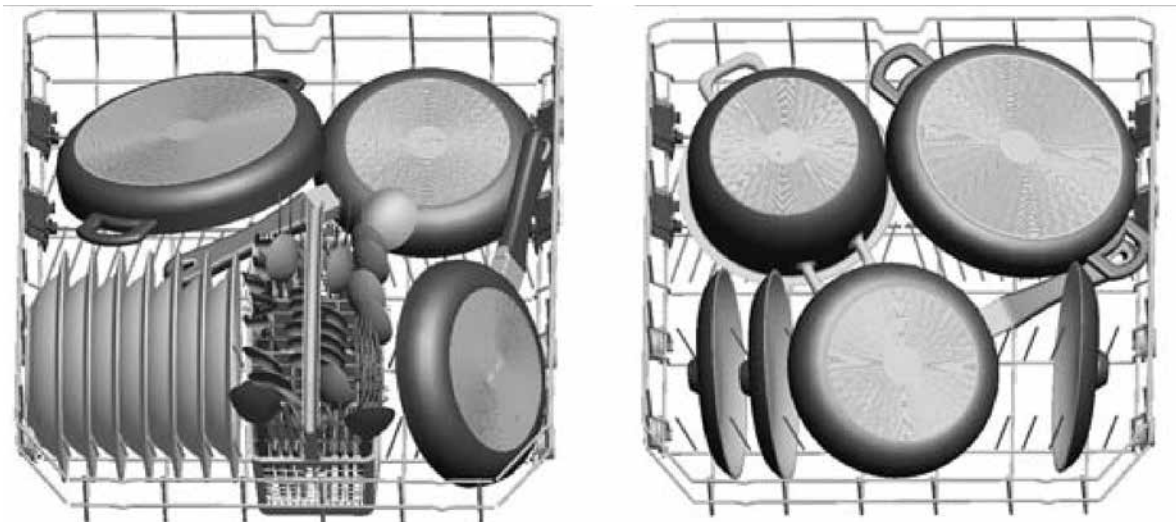

## MAINTENANCE AND CLEANING



### IMPORTANT

Cleaning the machine in regular intervals prolongs the machine's service life.

#### Oil and lime may accumulate in the machine's washing section. In case of such accumulation;

- Fill the detergent compartment without loading any dishes into the machine, select a program that runs at high temperature, and start the machine. In case of insufficiency, use special cleansing material available in the market. (Cleansing material produced special to machines by detergent producers.)

#### Cleaning the seals in the machine door

- To clean any accumulated residues in the door seals, wipe the seals regularly by using a dampened cloth.

#### Cleaning the machine

- Clean the filters and spray arms at least once a week.
- Unplug your machine and turn off its tap before starting the cleaning.
- Do not use hard materials when cleaning your machine. Wipe with a fine cleaning material and a dampened cloth.

#### Filters

- Check if any food wastes have remained on the coarse and fine filters.
- If any food wastes are left, remove the filters and clean them thoroughly under the water tap.

- a** Micro Filter
- b** Coarse Filter
- c** Metal/Plastic Filter

To remove and clean the filter combination, turn it counter clockwise and take it out by lifting upwards. **1**

Pull and remove the metal/plastic filter. **3**

Then pull the coarse filter out of the micro filter. **2**  
Rinse it with lots of water under the tap. Refit the metal/plastic filter. Insert the coarse filter into the micro filter in away that the marks will correspond to one another. Attach micro filter into the metal/plastic filter and turn to the direction of arrow and it is locked when the arrow on micro filter can be seen from across. **4**

- Never use your dishwasher without any filter.
- Incorrect fitting of the filter will reduce the washing effectiveness.
- Clean filters are very important in terms of the proper running of the machine.

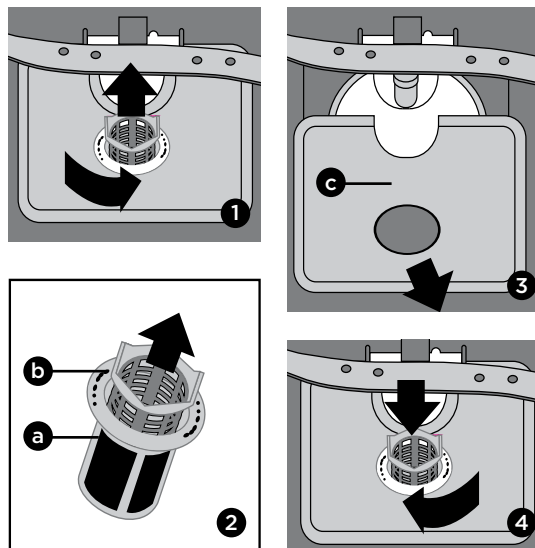

#### Spray arms

Check whether or not the holes for the upper and lower spray arms are clogged. If there is any clogging, remove the spray arms and clean them under water.

You can remove the lower spray arm by pulling it upwards, while the upper spray arm nut can be removed by turning the nut to the left.

Be sure that the nut is perfectly tightened when refitting the upper spray arm.

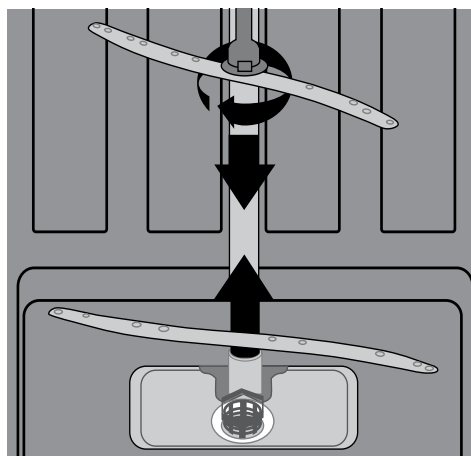

#### Hose filter

Water is stopped by the inlet hose filter to avoid any damage to your machine because of any contamination (sand, clay, rust etc.) that might be occasionally carried in through the mains water supply or the indoor plumbing, and to forestall such issues as yellowing and formation of deposits after washing. Check the filter and the hose from time to time and clean them if necessary.

To clean the filter, first turn off your tap and then remove the hose. After removing the filter from the hose, clean it under the tap. Insert the cleaned filter back into its place inside the hose. Refit the hose.

## TROUBLESHOOTING

ERROR CODE	ERROR DESCRIPTION	CONTROL
F1	Overfill	<ul style="list-style-type: none"> <li>• Power off your machine and close the tap.</li> <li>• Contact the customer service centre.</li> </ul>
F2	Not draining.	<ul style="list-style-type: none"> <li>• Water discharge hose is clogged.</li> <li>• The filters of your machine might be clogged.</li> <li>• Power off-on your machine and activate the program cancellation command.</li> <li>• If the error continues, contact the Customer Care Centre.</li> </ul>
F3	Inlet valve faulty	<ul style="list-style-type: none"> <li>• Close the tap.</li> <li>• Contact the Customer Care Centre.</li> </ul>
F5	Inadequate water supply	<ul style="list-style-type: none"> <li>• Make sure the water tap is fully open and that there is mains water available.</li> <li>• Close the water tap, disconnect the hose from the tap and clean the filter at the connection end of the hose.</li> <li>• Restart your machine, contact the service if the error resumes.</li> </ul>
F6	Faulty heater sensor	Contact the Customer Care Centre.
F7	Over temperature	Contact the Customer Care Centre.
F8	Heating error	Contact the Customer Care Centre.
F9	Divertor valve faulty	Contact the Customer Care Centre.
FE	Power supply problem	Contact the Customer Care Centre.





FOR SALES IN AUSTRALIA AND NEW ZEALAND  
APPLIANCE: WESTINGHOUSE DISHWASHERS

**This document sets out the terms and conditions of the product warranties for Westinghouse Appliances. It is an important document. Please keep it with your proof of purchase documents in a safe place for future reference should there be a manufacturing defect in your Appliance. This warranty is in addition to other rights you may have under the Australian Consumer Law.**

**1. In this warranty:**

- (a) 'ACL' or 'Australian Consumer Law' means Schedule 2 to the Competition and Consumer Act 2010;
- (b) 'Appliance' means any Electrolux product purchased by you and accompanied by this document;
- (c) 'ASC' means Electrolux's authorised serviced centres;
- (d) 'Westinghouse' is the brand controlled by Electrolux Home Products Pty Ltd of 163 O'Riordan Street, Mascot NSW 2020, ABN 51 004 762 341 in respect of Appliances purchased in Australia and Electrolux (NZ) Limited (collectively "Electrolux") of 3-5 Niall Burgess Road, Mount Wellington, in respect of Appliances purchased in New Zealand;
- (e) 'Warranty Period' means the period specified in clause 3 of this warranty;
- (f) 'you' means the purchaser of the Appliance not having purchased the Appliance for re-sale, and 'your' has a corresponding meaning.

**2. Application:** This warranty only applies to new Appliances, purchased and used in Australia or New Zealand and is in addition to (and does not exclude, restrict, or modify in any way) other rights and remedies under a law to which the Appliances or services relate, including any non-excludable statutory guarantees in Australia and New Zealand.

**3. Warranty Period:** Subject to these terms and conditions, this warranty continues for in Australia for a period of 24 months and in New Zealand for a period of 24 months, following the date of original purchase of the Appliance.

**4. Repair or replace warranty:** During the Warranty Period, Electrolux or its ASC will, at no extra charge if your Appliance is readily accessible for service, without special equipment and subject to these terms and conditions, repair or replace any parts which it considers to be defective. Electrolux may, in its absolute discretion, choose whether the remedy offered for a valid warranty claim is repair or replacement. Electrolux or its ASC may use refurbished parts to repair your Appliance. You agree that any replaced Appliances or parts become the property of Electrolux.

**5. Travel and transportation costs:** Subject to clause 7, Electrolux will bear the reasonable cost of transportation, travel and delivery of the Appliance to and from Electrolux or its ASC. Travel and transportation will be arranged by Electrolux as part of any valid warranty claim.

**6. Proof of purchase** is required before you can make a claim under this warranty.

**7. Exclusions:** You may not make a claim under this warranty unless the defect claimed is due to faulty or defective parts or workmanship. This warranty does not cover:

- (a) light globes, batteries, filters or similar perishable parts;
- (b) parts and Appliances not supplied by Electrolux;
- (c) cosmetic damage which does not affect the operation of the Appliance;

- (d) damage to the Appliance caused by:
  - (i) negligence or accident;
  - (ii) misuse or abuse, including failure to properly maintain or service;
  - (iii) improper, negligent or faulty servicing or repair works done by anyone other than an Electrolux authorised repairer or ASC;
  - (iv) normal wear and tear;
  - (v) power surges, electrical storm damage or incorrect power supply;
  - (vi) incomplete or improper installation;
  - (vii) incorrect, improper or inappropriate operation;
  - (viii) insect or vermin infestation;
  - (ix) failure to comply with any additional instructions supplied with the Appliance;

In addition, Electrolux is not liable under this warranty if:

- (a) the Appliance has been, or Electrolux reasonably believes that the Appliance has been, used for purposes other than those for which the Appliance was intended, including where the Appliance has been used for any non-domestic purpose;
- (b) the Appliance is modified without authority from Electrolux in writing;
- (c) the Appliance's serial number or warranty seal has been removed or defaced

**8. How to claim under this warranty:** To enquire about claiming under this warranty, please follow these steps:

- (a) carefully check the operating instructions, user manual and the terms of this warranty;
- (b) have the model and serial number of the Appliance available;
- (c) have the proof of purchase (e.g. an invoice) available;
- (d) telephone the numbers shown below.

**9. Australia:** For Appliances and services provided by Electrolux in Australia: Electrolux goods come with guarantees that cannot be excluded under the Australian Consumer Law. You are entitled to a replacement or refund for a major failure and for compensation for any other reasonably foreseeable loss or damage. You are also entitled to have the Appliance repaired or replaced if the Appliance fails to be of acceptable quality and the failure does not amount to a major failure. 'Acceptable quality' and 'major failure' have the same meaning as referred to in the ACL.

**10. New Zealand:** For Appliances and services provided by Electrolux in New Zealand, the Appliances come with a guarantee by Electrolux pursuant to the provisions of the Consumer Guarantees Act, the Sale of Goods Act and the Fair Trading Act. Where the Appliance was purchased in New Zealand for commercial purposes the Consumer Guarantee Act does not apply.

**11. Confidentiality:** You accept that if you make a warranty claim, Electrolux and its agents including ASC may exchange information in relation to you to enable Electrolux to meet its obligations under this warranty.

**Important Notice**

Before calling for service, please ensure that the steps listed in clause 8 above have been followed.

<b>FOR SERVICE</b> or to find the address of your nearest authorised service centre in Australia <b>PLEASE CALL 13 13 49</b> <small>For the cost of a local call (Australia only)</small>	<b>AUSTRALIA</b> ELECTROLUX HOME PRODUCTS 163 O'Riordan Street, Mascot NSW 2020 electrolux.com.au	<b>FOR SPARE PARTS</b> or to find the address of your nearest spare parts centre in Australia <b>PLEASE 13 13 50</b> <small>For the cost of a local call (Australia only)</small>
<b>FOR SERVICE</b> or to find the address of your nearest authorised service centre in New Zealand <b>PLEASE CALL 0800 10 66 10</b> <small>(New Zealand only)</small>	<b>NEW ZEALAND</b> ELECTROLUX (NZ) Limited 3-5 Niall Burgess Road, Mount Wellington electrolux.co.nz	<b>FOR SPARE PARTS</b> or to find the address of your nearest spare parts centre in New Zealand <b>PLEASE 0800 10 66 20</b> <small>(New Zealand only)</small>

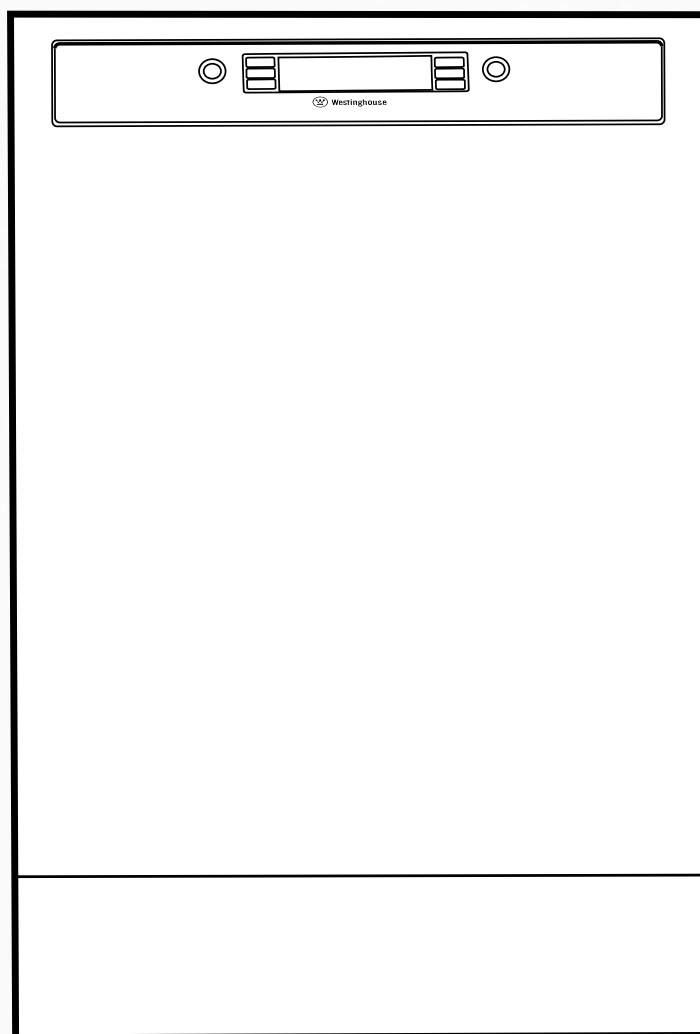

## **DISHWASHER**

WSF67251



## CONGRATULATIONS

Dear customer,

Congratulations on the purchase of your new Westinghouse dishwasher.

Before you use the dishwasher, we recommend that you read through the whole user manual which provides the description of the dishwasher and its functions.

To avoid the risks that are always present when you use an electrical appliance, it is important that the dishwasher is installed correctly and that you read the safety instructions carefully to avoid misuse and hazards.

We recommend that you keep this instruction booklet for future reference and pass it on to any future owners.

After unpacking the appliance, please check it is not damaged. If in doubt, do not use the appliance but contact your local Customer Care Centre.

For contact details, refer to the last page of this user manual.

### Conditions of use

This appliance is intended to be used in household and similar applications such as:

- Staff kitchen areas in shops, offices and other working environments
- Farm houses
- By clients in hotels, motels and other residential type environments
- Bed and breakfast type environments

**Please ensure you read the instruction manual fully before you call for service, or a full service fee could be applicable.**

Record model and serial number here:

Model number:.....

Serial number:.....

PNC:.....

## CONTENTS

Safety information.....	3
Safety instructions.....	4
Product description.....	5
Technical specifications.....	5
Control panel.....	6
Control description.....	7
Programs.....	8
Settings.....	9
Hints and tips.....	10
Installation.....	11
Preparing for use.....	14
Loading.....	16
Maintenance and cleaning.....	21
Troubleshooting.....	22
Warranty.....	23

Please read the user manual carefully and store in a handy place for later reference.

The symbols you will see in this booklet have these meanings:



### WARNING

This symbol indicates information concerning your personal safety.



### CAUTION

This symbol indicates information on how to avoid damaging the appliance.



### IMPORTANT

This symbol indicates tips and information about use of the appliance.



### ENVIRONMENT

This symbol indicates tips and information about economical and ecological use of the appliance.

### IMPORTANT INFORMATION THAT MAY IMPACT YOUR MANUFACTURER'S WARRANTY

Adherence to the directions for use in this manual is extremely important for health and safety. Failure to strictly adhere to the requirements in this manual may result in personal injury, property damage and affect your ability to make a claim under the Westinghouse manufacturer's warranty provided with your product. Products must be used, installed and operated in accordance with this manual. You may not be able to claim on the Westinghouse manufacturer's warranty in the event that your product fault is due to failure to adhere this manual.

## GENERAL WARNINGS

Please read the user manual carefully and store in a handy place for later reference. Pass the user manual on to possible new owners of the appliance.

Read the following carefully to avoid damage or injury.

**Note: You must read these warnings carefully before installing or using the appliance. If you need assistance, contact your Customer Care Department. The manufacturer will not accept liability, should these instructions or any other safety instructions incorporated in this book be ignored.**

### Children and vulnerable people safety.



#### WARNING

Risk of injury or permanent disability.

This appliance can be used by children aged from 8 years and above and persons with reduced physical, sensory or mental capabilities or lack of experience and knowledge if they have been given supervision or instruction concerning use of the appliance in a safe way and understand the hazards involved.

- Do not let children play with the appliance.
- Keep all detergents away from children.
- Keep children and pets away from the appliance door when it is open.
- Cleaning and user maintenance shall not be made by children without supervision.



#### WARNING

It is important to use your appliance safely. Check these safety points before using your appliance.

### General Safety

- Do not change the specification of this appliance.
- The operating water pressure (minimum and maximum) must be between 0.5 (50) / 8 (800) bar (kPa)
- Obey the maximum number of 15 place settings.
- If the supply cord is damaged, it must be replaced by the manufacturer, its Authorised Service Centre or similarly qualified persons in order to avoid a hazard.
- Put knives and cutlery with sharp points in the cutlery basket with the points down or in a horizontal position.
- Do not leave the appliance door open without supervision to prevent causing a trip hazard.
- Before maintenance, turn the appliance off and disconnect the plug from the mains.
- Do not use water spray and steam to clean the appliance.
- The appliance is to be connected to the water mains using the new supplied hose-sets. Old hose sets must not be reused.
- The ventilation openings in the base (if applicable) must not be obstructed.
- Some dishwasher detergents are strongly alkaline. They can be extremely dangerous if swallowed. Avoid contact with the skin and eyes and keep children away from the dishwasher when the door is open.
- Check that the detergent receptacle is empty after completion of the wash cycle.

### Installation

- Remove all the packaging.
- Do not install or use a damaged appliance.
- Do not install or use the appliance where the temperature is less than 0°C.
- Obey the installation instruction supplied with the appliance.
- Make sure that the appliance is installed below and adjacent to safe structures.

## SAFETY INSTRUCTIONS



### WARNING

Risk of fire and electrical shock.

#### Electrical connection

- The appliance must be earthed.
- Make sure that the electrical information on the rating plate is the same as the power supply. If not, contact an electrician.
- Always use a correctly installed shockproof socket.
- Do not use multi-plug adapters and extension cables.
- Make sure not to cause damage to the mains plug and to the mains cable. Should the mains cable need to be replaced, this must be carried out by our Authorised Service Centre.
- Connect the mains plug to the mains socket only at the end of the installation. Make sure that there is access to the mains plug after the installation.
- Do not pull the mains cable to disconnect the appliance. Always pull the mains plug.

#### Water connection

- Make sure not to cause damage to the water hoses.
- Before you connect the appliance to new pipes or pipes not used for a long time, let the water flow until it is clean.
- The first time you use the appliance, make sure that there is no leakage.
- The water inlet hose has a safety valve and a sheath with an inner mains cable.

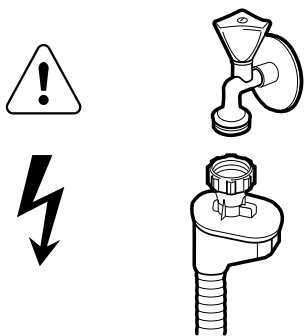

### WARNING

Dangerous voltage

- If the water inlet hose is damaged, immediately disconnect the mains plug from the mains socket. Contact the Authorised Service Centre to replace the water inlet hose.

#### Use

- Do not sit or stand on the open door.
- Dishwasher detergents are dangerous. Obey the safety instructions on the detergent packaging.
- Do not drink and play with the water in the appliance.
- Do not remove the dishes from the appliance until the program is completed. There can be detergent on the dishes.
- The appliance can release hot steam if you open the door while a program operates.
- Do not put flammable products or items that are wet with flammable products in, near or on the appliance.



### WARNING

Risk of injury or suffocation.

#### Disposal

- Disconnect the appliance from the mains supply.
- Cut off the mains cable and discard it.
- Remove the door catch to prevent children and pets to get closed in the appliance.

## PRODUCT DESCRIPTION

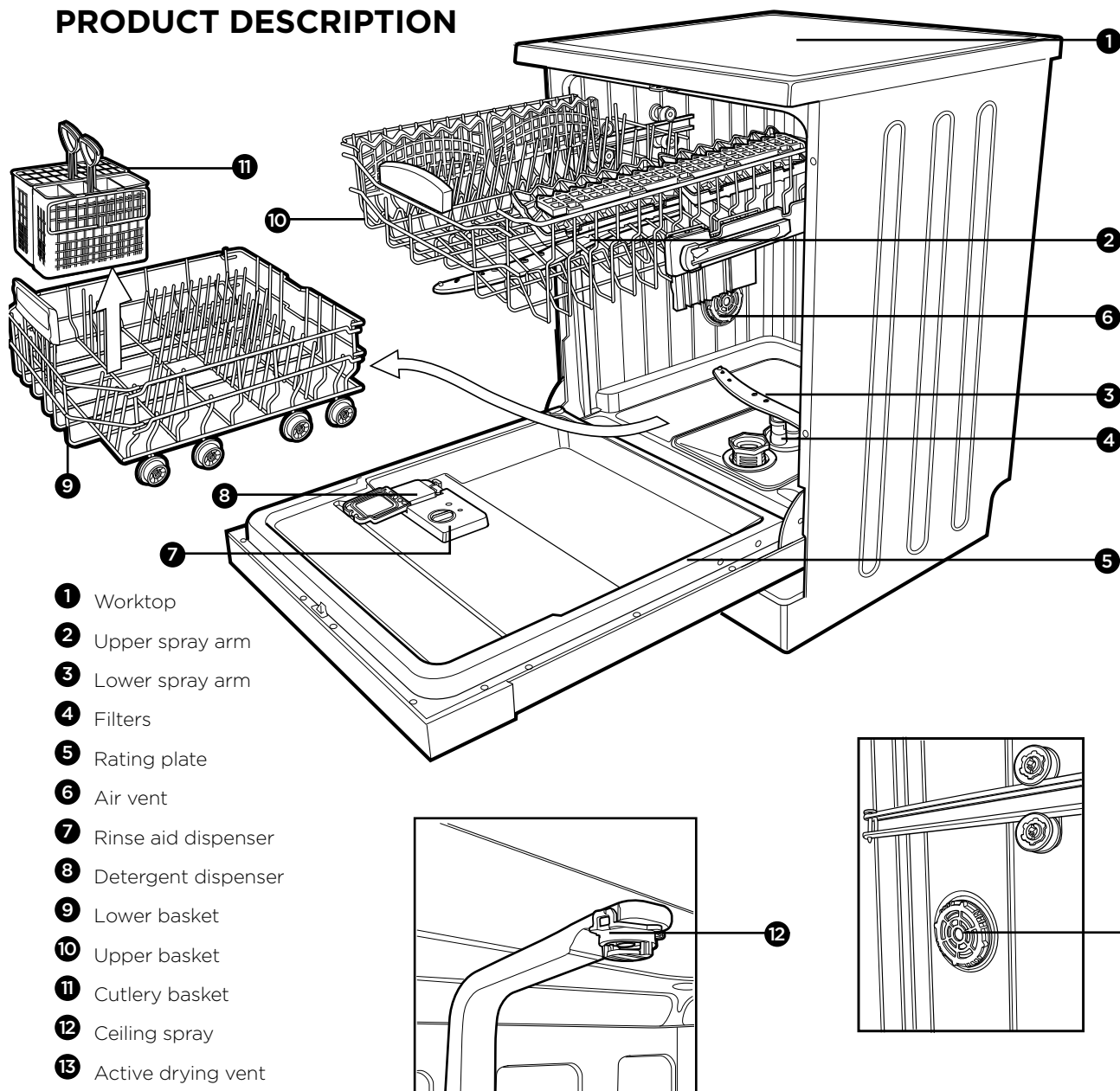

## TECHNICAL SPECIFICATIONS

MODEL	WSF67251 - freestanding
Capacity	15 place settings
Height	850mm
Height (without worktop)	820mm
Width	598mm
Depth	598mm
Net weight	54kg
Electricity input	220-240 V, 50 Hz
Current	10 A
Total power	1900W
Water supply pressure	max. 1MPa min. 0.03MPa
Water supply	hot or cold water max. 60°C 10L/min

## CONTROL PANEL

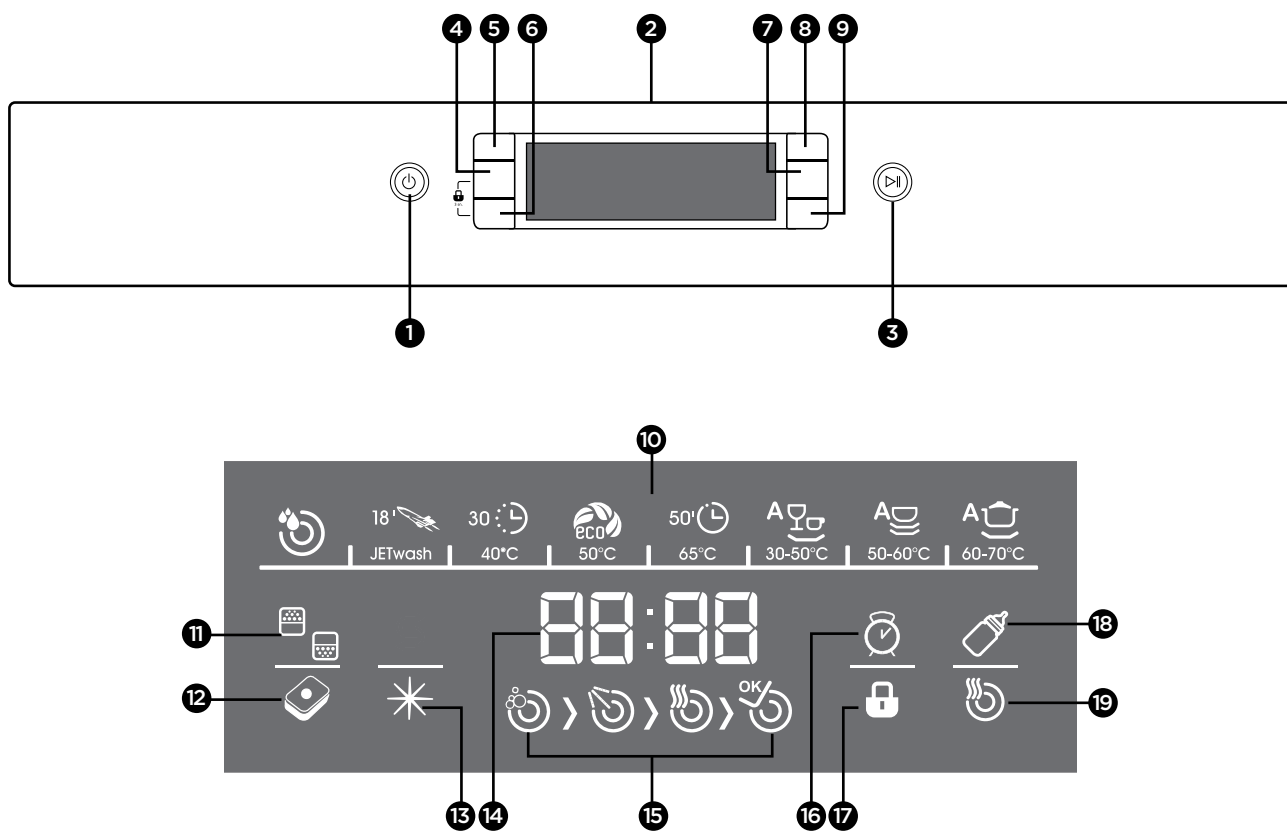

- |                               |                                    |
|-------------------------------|------------------------------------|
| 1 On/off button               | 13 Rinse aid level warning display |
| 2 Door handle                 | 14 Remaining time/delay            |
| 3 Start/standby button        | 15 Progress indicator              |
| 4 FlexZone button             | • Washing phase                    |
| 5 Program button              | • Rinsing phase                    |
| 6 Tablet detergent button     | • Drying phase                     |
| 7 Hygiene button              | • End indicator                    |
| 8 Delay button                | 16 Delay indicator                 |
| 9 Dry Plus button             | 17 Child Lock indicator            |
| 10 Program displays           | 18 Hygiene indicator               |
| 11 FlexZone indicator         | 19 Dry Plus indicator              |
| 12 Tablet detergent indicator |                                    |

# CONTROL DESCRIPTIONS

## Power on/off button ①

When you press the on/off button, the machine is switched on and the display shows the Eco 50 program, the dishwasher is off when the LEDs on the display are off.

## Door handle ②



Use the door handle to open/close the door of your dishwasher.

## Start/Standby button ③

When the start/standby button is pressed, the program selected with the program button will start and the progress indicator display will show the washing image  ⑬. The progress indicator display will show the washing phases. ⑮

## FlexZone button ④

The FlexZone function allows dishes to be washed in the upper basket only, lower basket only or both upper and lower baskets to cater for every load size.

If you do not have a full load of dishes in your machine you can also activate the FlexZone function for some programs.   If you have dishes in both baskets, press the FlexZone button and select the position in which both lamps are highlighted.

 If you have dishes only in the upper basket, press the FlexZone button and select the position in which the upper image is illuminated. Thus, washing up shall be done only on the upper basket of your machine.

 If you have dishes only in the lower basket, press the  $\frac{1}{2}$  key and select the position in which the lower image is illuminated. Thus, washing up shall be done only on the lower basket of your machine. When using this feature, make sure that there are no dishes in the upper basket.

## Program button ⑤

Select the appropriate washing program from the display using the program button. ⑩

## Tablet detergent button ⑥

Press the tablet detergent button whenever using tablets. If this button is active for the program you have selected, indicator ⑫ will be illuminated on the display.

## Dry Plus button ⑦

Using this button, you may add extra drying to the program you have selected.

When you select the extra drying function, indicator ⑰ is illuminated on the display. Using this function, you may add more drying steps to the program you have selected and consequently obtain drier dishes.

## Delay button ⑧

Once a program is selected and before the program starts, you may adjust the delay time by pressing the delay button. The program start can be delayed from 1-24 hours. When you press the delay button, indicator ⑯ will be illuminated on the display.

## Hygiene button ⑦

Select this button to obtain extra hygiene, this will alter the water temperature and washing time of the program you have selected. When you select the hygiene function, indicator ⑱ will be illuminated on the display.

## Rinse aid level warning display ⑬

In order to understand whether the rinse agent in your machine is sufficient or not, please check the rinse agent level warning display. If this display is illuminated, fill the rinse agent section.

## Remaining time delay display ⑭

The remaining time display shows the duration of the programs and the remaining time while the program is in operation. If you have selected a delay time, the display will count down the delay time and then the program time.

## Use of child lock

In order to activate the child lock, press both "tablet detergent" and "FlexZone" buttons at the same time for 3 seconds. In the meantime, you will see "CL" for 2 seconds on the Remaining time display. In order to deactivate, press both "tablet" and "FlexZone" buttons at the same time for 3 seconds. "CL" will flash two times.

## PROGRAMS

DISPLAY SYMBOL								
PROGRAM	PREWASH	QUICK 18 MINS	FAST 30 MINS 40°C	ECO 50°C	TIMESAVE 50 MINS	AUTO	AUTO	AUTO
WASHING TEMP	35°C		40°C	***50°C	65°C	30-50°C	50-60°C	60-70°C
FOOD RESIDUE TYPE	Fresh light contamination, coffee, milk, tea	Fresh light contamination, coffee, milk, tea	Fresh light contamination, coffee, milk, tea, cold meat, vegetables	Fresh light contamination, coffee, milk, tea, cold meat, vegetables	Old soups, sauces, pastries, egg, rice potato and oven foods, fried foods	Old soups, sauces, pastries, egg, rice potato and oven foods, fried foods		
SOIL LEVEL	Low	Low	Low	Normal	Medium	High	High	High
DETERGENT AMOUNT B: 25CM <sup>3</sup> /15CM <sup>3</sup> A: 5CM <sup>3</sup>	-	**A	B	A+B	A+B	A+B	A+B	A+B
PROGRAM DURATION (MINUTES)	15	18	30	155	50	64-92	100-121	111-179
POWER CONSUMPTION	0.02	0.57	0.76	0.79	1.29	0.80-0.99	1.13-1.46	1.30-1.95
WATER CONSUMPTION	4.2	7.7	10.9	13.5	10.7	10.6-17.7	10.9-18.5	12.3-24.6
VALUES WHEN FLEX ZONE FEATURE IS USED								
PROGRAM DURATION (MINUTES)	15	18	30	148	46	62-80	82-101	123-159
POWER CONSUMPTION	0.02	0.57	0.76	0.75	1.25	0.77-0.96	1.10-1.43	1.10-1.43
WATER CONSUMPTION	4.2	7.7	10.9	13.5	10.7	9.9-13.7	10.5-14.3	11.9-19.9
SELECTABLE OPTIONS								
	FlexZone	FlexZone	FlexZone	FlexZone	FlexZone	FlexZone	FlexZone	FlexZone
			Dry Plus	Dry Plus	Dry Plus	Dry Plus	Dry Plus	Dry Plus
				Hygiene	Hygiene	Hygiene	Hygiene	Hygiene
			Tablet	Tablet	Tablet	Tablet	Tablet	Tablet

\* The Quick 18 minute program can be used for lightly soiled dishes and suitable for washing 4 place settings.

\*\* The Quick 18 minute program should use only powder detergent.

\*\*\* With this program you have the most efficient use of water and energy consumption for crockery and cutlery for normal soil. (This is the standard program for Test Institutes).

### Information for test institutes

For all the necessary information for test performance; send an email to [dishwasher@standardtest.info](mailto:dishwasher@standardtest.info) and provide the model and PNC number on the rating plate.



### CAUTION

The Quick 18 minute, Fast 30 minute and TimeSave 50 minute programs do not have a drying step.

The values stated above are values that are obtained in laboratory environment relative to related standards.

These values can change according to the product's usage and environment (mains voltage, water pressure, water inlet temperature and ambient temperature).

## SETTINGS

### Starting the machine

1. Press on/off switch. **1**
2. Select the appropriate program for your dishes using the program button. **5**
3. If you prefer, you can select additional functions. **4 6 7 9**
4. Start the program by pressing the start/standby button. **3**

### Program follow-up

You can follow the progress by the help of the program follow-up symbols on the display. **15**

As the washing proceeds, respective washing and rinsing symbols will be illuminated.  

When the drying symbol is on, the machine remains silent for about 45-50 minutes. 

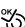
Do not open the door before the end indicator is illuminated. When the program finishes, end indicator is illuminated. 

When the program you have selected starts, you may see the estimated remaining time in the time indicator display.



*NOTE: The total time that programs take can differ according to ambient temperature, the temperature of the mains water and the amount of dishes; therefore the program may take a different amount of time than that initially stated.*

### Program follow-up

Once the selected program starts, should you wish to change to a different program;

- Press on start/standby button. **3**
- Select the new program using program button. **5**
- The newly selected program continues from where the previous one was left.
- Start the program by pressing the start/standby button again. **3**

### Cancelling program

If you want to cancel the program once it has started;

- Hold the start/standby button for 3 seconds. **3**
- The display will count down from 3 to 1 and when the countdown is over, the remaining time will be displayed as 1 minute.

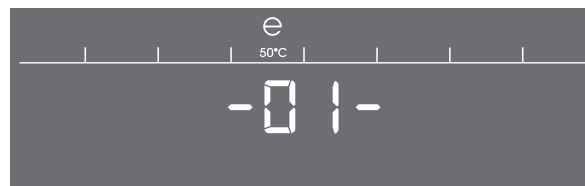
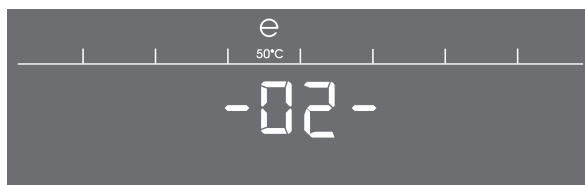
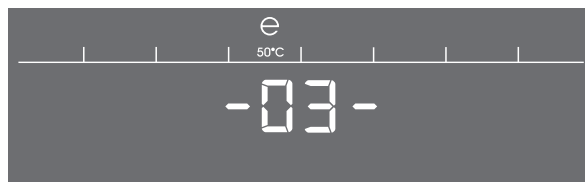

The machine will empty all the water in this 1 minute; the time is reset and completion symbol is illuminated.

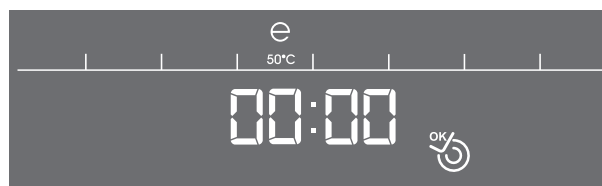
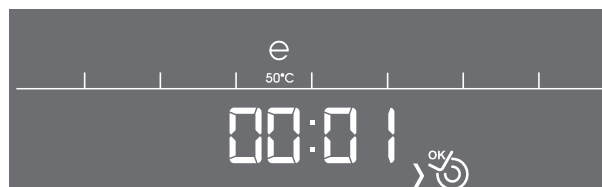

### Switching off the dishwasher

- When the end indicator is illuminated, switch off your machine by pressing the on/off button.
- Later, unplug your machine and turn off its faucet.

*NOTE: To improve drying results with the most efficient use of energy, open the door approximately 10cm when the program is finished and the end indicator is illuminated. Leave door ajar and allow the dishes to cool for 30-40mins.*

*If the machine door is opened or a power failure occurs during washing, the machine will resume the cycle where it stopped when the door is closed or power is restored.*



## HINTS AND TIPS

### If one of program monitor lights is on and start/pause light is flashing

- Your machine's door is open, shut the door to continue.

### If the program won't start

- Check if the plug is connected.
- Check your indoor fuses.
- Check that the water inlet tap is turned on.
- Check that you have closed the machine door.
- Check that you switched off the machine by pressing the power on/off button.
- Check that the water inlet filter and the machine filters are not clogged.

### If the control light is off after a wash operation

- The power on/off button isn't released yet.

### If detergent residues are left in the detergent compartment

- Detergent has been added when the detergent compartment was wet.
- Large dishes have blocked the dispenser door.

### If water is left inside the machine at the end of the program

- The water drain hose is clogged or twisted.
- The filters are clogged.
- The program is not finished yet.



### IMPORTANT

At the end of the program, water may still remain on the sides and door of the appliance.

### If the machine stops during a wash operation

- Power failure.
- Water inlet failure.
- Program is on standby mode.

### If shaking and hitting noises are heard during a wash operation

- Dishes are placed incorrectly.
- The spray arm is hitting the dishes.

### If there are partial food wastes left on the dishes

- Dishes are placed incorrectly into the machine, sprayed water did not reach related places.
- Basket overloaded.
- Dishes leaning against one another.
- Very small amount of detergent added.
- An unsuitable, rather weak wash program selected.
- Spray arm clogged with food waste.
- Filters clogged.
- Filters incorrectly fitted.
- Water drain pump clogged.

### If there are white stains on the dishes

- A very small amount of detergent is being used.
- Rinse aid dosage setting at a very low level.
- Water hardness is very high.

### If the dishes won't dry

- A program without a dry operation selected.
- Rinse aid dosage set too low.
- Dishes unloaded too fast.
- Use a hotter program

### If there is rust on the dishes

- Stainless-steel quality of the dishes washed is insufficient.
- High level of salt in the wash water.
- Unhealthy mains grounding.

### Unloading the baskets

- For improved drying results with the most effective use of energy, open the door approximately 10cm at the end of the program.
- Allow the tableware to cool for 30-40 minutes as hot items can easily be damaged.
- First remove items from the lower basket before removing the items from the upper basket.

### Call an authorised service if the problem still persists after the controls or in case of any malfunction not described above.

### Useful Information

- Whenever you will not be operating your machine:
  - Unplug the machine and then turn water off.
  - Leave the door slightly ajar in order to prevent the formation of unpleasant smells.
- Keep the machine interior clean.
- Correct loading of dishes in the machine, enables reduced energy consumption and improved washing and drying performance.
- Remove all large food remnants before you placing dirty dishes into the machine.
- Operate the machine after it is completely full.
- If the appliance is located in a place where the risk of freezing exists, you must completely drain the water that has remained in the machine. Turn off the water tap, disconnected the water inlet hose from the tap and allow the interior water to drain.

# INSTALLATION

## General

- When determining where to put your machine, choose a place where you can easily load and unload your dishes.
- Do not put your machine in any location where there is a probability for the room temperature to fall below 0°C.
- Before positioning, take the machine out of its packaging by following the warnings located on the package.
- Position the machine close to a water tap or drain. You need to site your machine, taking into consideration that its connections will not be altered once they are made.
- Do not grip the machine by the door in order to move it.
- Leave a clearance on all sides of the machine so that you can comfortably move it back and forth during cleaning.
- Make sure that the water inlet and outlet hoses aren't squeezed while positioning the machine. Also, make sure that the machine does not stand on the electrical cable.
- Adjust the machine's adjustable feet so that it can stand level and balanced. Proper positioning of the machine ensures problem-free opening and closing of the door.
- If the door of your machine does not close properly, check if the machine is stable on the floor it stands; if not, adjust the feet and ensure its stable position.

## Water connection

Connect the inlet hose to a water tap with an external BSP thread spout of 3/4". The indoor plumbing is to comply with AS/NZS 3500.1.

For best washing performance it is recommended to connect the appliance to a cold water supply.

Energy savings can be made by connecting the appliance to a solar water system and using economy options, however the water temperature must not exceed 60°C

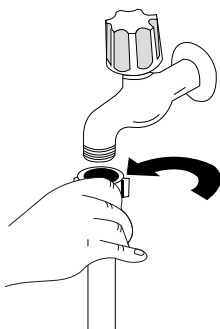

### CAUTION

Only turn the locking nut to secure the hose. Do not turn the hose.

## Inlet water supply

- Water pressure: 800kPa max – 50 kPa min.
- Water flow rate 10 L/minute
- If water pressure is in excess of 800 k Pa, a pressure reducing valve should be used. Check for leaks.
- If water temperature is in excess of 60°C, a tempering valve should be used. Check for leaks.



### CAUTION

Always use new hoses when you connect the appliance to the water mains. Old hoses must not be used. The water inlet hose must be examined at an interval of twelve months for deterioration and replaced if necessary.

In order to pass the safety valve through the kitchen cabinets, an opening of at least 45mm x 90mm is needed.

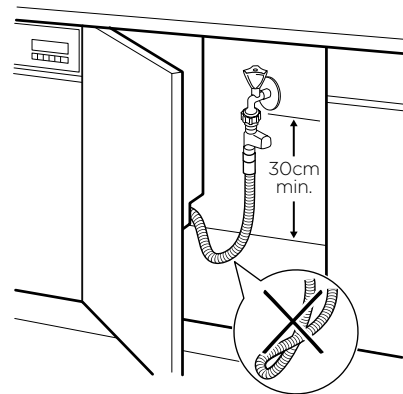

## Water drain hose

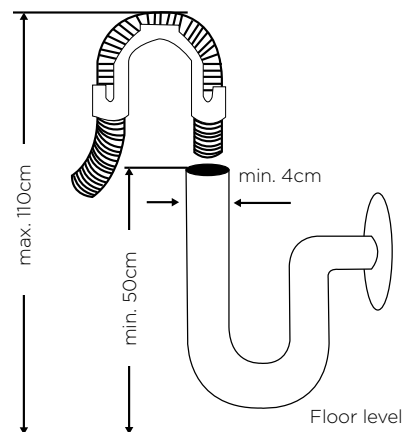

The water drain hose can be connected either directly to the water drain hole or to the sink outlet spigot. Using a special bent pipe (if available), the water can be drained directly into the sink via hooking the bent pipe over the edge of the sink. This connection should be at a minimum of 50cm and at a maximum of 110cm from the floor.



### CAUTION

When a drain hose longer than 4m is used, the dishes won't be cleaned properly and might remain dirty.

## INSTALLATION

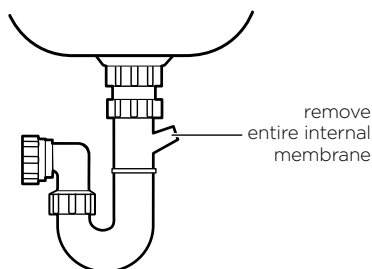

Correct

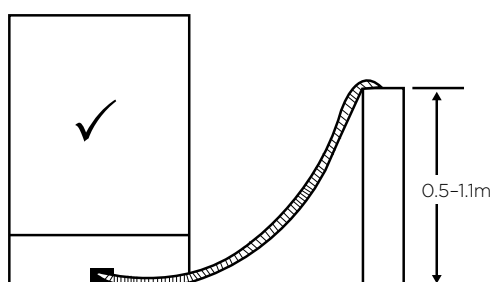

Incorrect

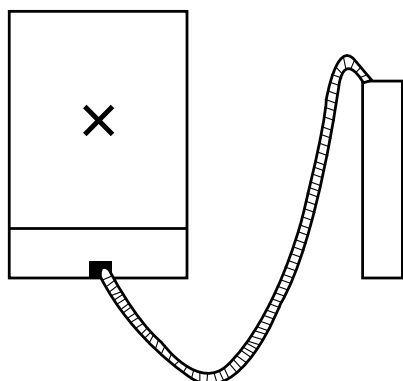

### Installing a freestanding dishwasher

If the under counter height is greater than 850mm, the dishwasher can be installed without removing the worktop.

If the under counter space is less than 850mm but greater than 820mm the worktop will need to be removed.

To remove the worktop, remove the screws located at the rear of the machine, then, from the front, push the worktop towards the rear and lift.

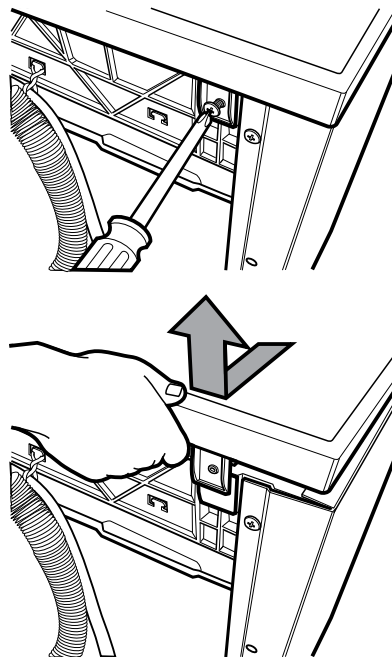

To ensure stability of the dishwasher in an undercounter installation, any gap between the dishwasher and the underside of the countertop should be bridged with a packing piece. This may be achieved by wedging a piece of timber between the dishwasher and the underside of the countertop.

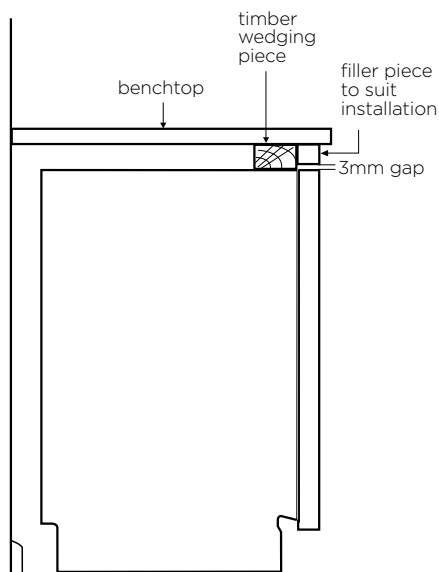

## INSTALLATION

In some cases you may need to remove the top concrete counterweight and trim the felt with a knife. To remove the counterweight, follow the steps below.

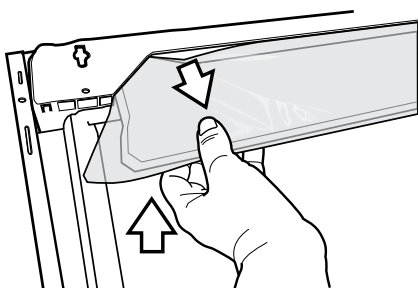
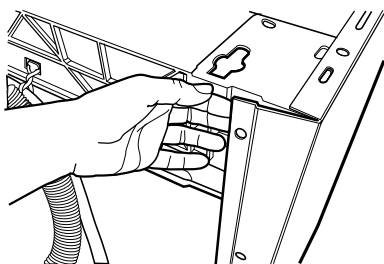
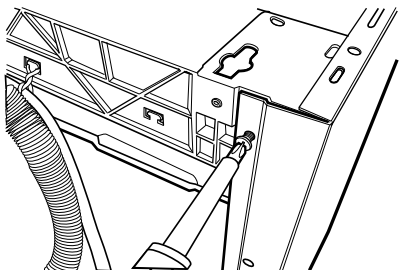

### CAUTION

If the counterweight has been removed, the dishwasher must be stabilised by wedging a piece of timber between the dishwasher and the underside of the countertop.

To remove the felt and the dishwasher support blocks: Lift and cut felt.

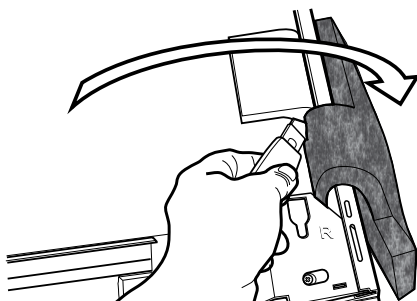

Remove 2 blocks of foam as shown.

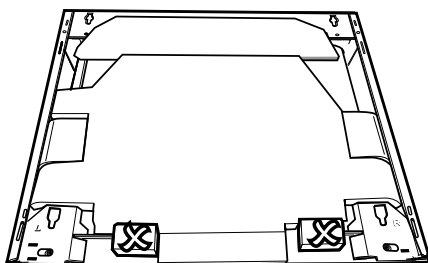

## Finishing the installation

1. Fit the steam protection tape to the underside of the countertop.



2. Adjust the dishwasher feet according to the slope of the floor then carefully slide the dishwasher into the cavity.

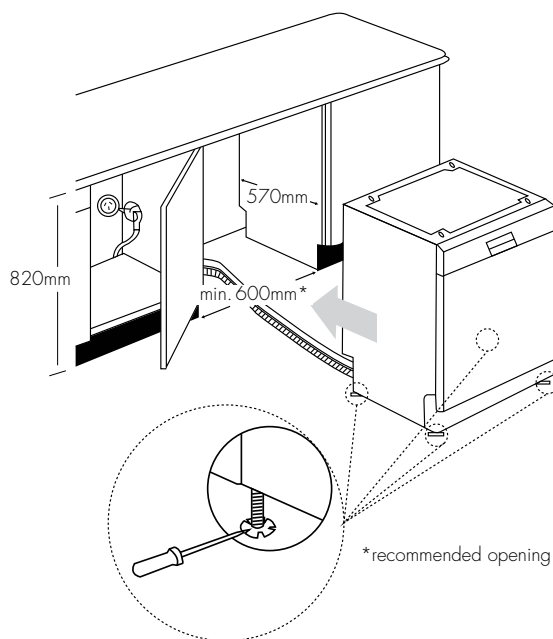

### CAUTION

When installing the dishwasher into the cavity, take care not to crush or kink the hoses or electrical cable.

## PREPARING FOR USE

### Detergent usage

Use a detergent specifically designed for use in domestic dishwashers. You can find powder, gel and tablet detergents in the market that have been designed for household dishwashers. Detergent should be put into the compartment prior to starting the machine. Keep your detergents in cool, dry places out of reach of children. Do not fill detergent into the detergent compartment more than required; otherwise it may cause scratches on your glasses as well as lead to a poorly dissolved detergent. Should you need more information concerning the detergent you will use, contact detergent manufacturers directly.

### Filling the detergent compartment

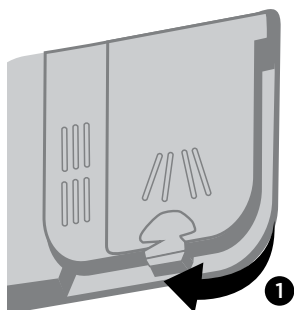

Push the latch to open the detergent container as shown in the image ①. Detergent pod has level lines inside, measure the detergent amount using these lines. Detergent pod can take a total of 40cm<sup>3</sup> detergent.

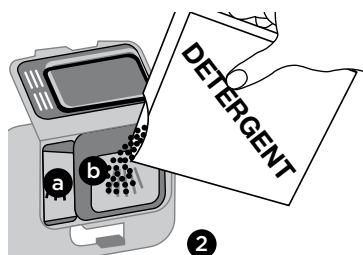

If your dishes are heavily soiled, pour dishwashing detergent into the larger compartment ② (25cm<sup>3</sup>) or if slightly soiled the smaller compartment (15cm<sup>3</sup>). If your dishes have been dirty for a long period, if there is dried food waste on them and if you have overly loaded the dishwasher, pour a 5cm<sup>3</sup> detergent into the pre-wash compartment ③ and start your machine.

You may have to add more detergent into your machine, depending on the degree of soil and on the water hardness level.

### Combined detergent

Detergent manufacturers also produce combined detergents called “2 in 1”, “3 in 1” or “5 in 1” etc. “2 in 1” detergents contain detergent + rinse aid. When using “2 in 1” detergents make sure to check the specifications of the tablet.

Other tablet detergents contain detergent + rinse aid + various extra functions.

Generally, combined detergents produce suitable results under certain usage conditions only.

These detergents contain rinse aid and/or other additives in preset amounts.

### Points to consider when using these type of products:

- Always make sure to check the specifications of the product you will use or whether or not it is a combined product.
- Check if the detergent used is appropriate for the hardness of mains water that machine relates to.
- Observe the instructions on packaging when using such products.
- If such detergents are in the form of tablets, never put them into the interior section or the cutlery basket of the dishwasher. Always put the tablets into the detergent compartment in the detergent dispenser.
- They produce good results for certain types of usage only. If you are using this type of detergent, you need to contact the manufacturers and find out about the suitable conditions of use.
- When the conditions of use of such products and the machine settings are appropriate, they ensure savings in salt and/or rinse aid consumption.
- Contact the detergent manufacturer if you are not obtaining good wash results (if your dishes stay calcareous and wet) after having used 2 in 1 or 3 in 1 detergents. The scope of warranty for your machine does not cover any complaints caused by the use of these types of detergents.

### Recommended usage:

For better results while using combined detergents, add rinse aid to your machine and adjust the rinse aid setting to the lowest position.

## PREPARING FOR USE



### CAUTION

Solubility of the tablet detergents produced by different companies can vary depending on the temperature and time. Therefore, it is not recommended to use such detergents in short programs. It is more suitable to use powder detergents in such programs.

Should any problem, which you have not encountered before, arise with the use of this type of detergents, contact the detergent manufacturers directly.

### When you give up using combined detergents

- Fill the salt and rinse aid compartments.
- Adjust the water hardness setting to the highest position (6) and run an empty-wash.
- Adjust the water hardness level.
- Make the suitable rinse aid setting.

### Filling with rinse aid and making the setting

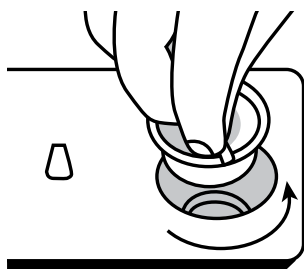

Rinse aid is used to prevent the stay of white water drops, lime stains, white film strip-shaped stains that may form on the dishes, as well as to increase the drying performance. Contrary to the popular beliefs, it is used not only for obtaining shinier dishes but also for obtaining sufficiently dried dishes. For this reason, care should be taken that there is adequate amount of rinse aid in the rinse aid compartment and only polishing material produced for use at dishwashers should be used. If the rinse aid lamp on the control panel becomes on fill the rinse aid compartment with rinse.

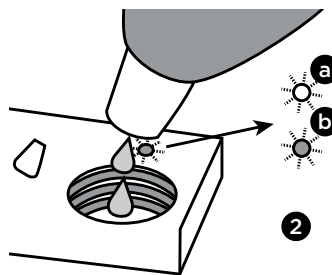

To put rinse aid, remove the rinse aid compartment cap by turning it. Fill the rinse aid compartment with rinse aid until the rinse aid level indicator becomes dark **1**; refit the cap and close it by turning it in a way that the nails will correspond to one another **2**. By checking the rinse aid level indicator on the detergent dispenser, you can understand whether or not your machine needs rinse aid. A dark indicator **b** means that there is rinse aid in the compartment, while a light indicator **a** shows that you need to fill the compartment with rinse aid.

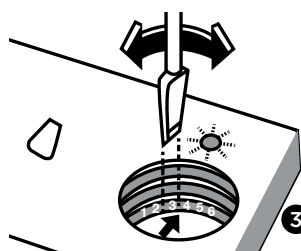

The rinse aid level adjuster can be set to a position between 1 and 6. Factory setting for rinse aid is the position 3. You need to increase the degree of the adjuster if water stains form on your dishes after a wash, whereas you need to decrease the degree if a blue stains left when wiped by hand. **3**



### CAUTION

Use only those rinse aid materials which are allowed for use in the machine. As rinse aid residues left as a result of overflowing will create extremely high amounts of foam and thus reduce the washing performance, remove the excess amount of rinse aid by wiping it with a paper towel or cloth.

## LOADING YOUR DISHWASHER

If your dishes are correctly placed in the dishwasher, you will be using it in the best way in terms of energy consumption, washing and drying performance.

There are two separate baskets for you to load your dishes into your machine. You can load into the lower basket such round and deep items as pots with long handles, pot lids, plates, salad plates, cutlery sets.

The upper basket has been designed for tea plates, dessert plates, salad bowls, cups and glasses. When placing long-stem glasses and goblets, lean them against the basket edge, rack or glass supporter wire and not against other items. Do not lean long glasses against one another or they won't remain steady and can be damaged.

It is recommended that thin narrow items be placed into the middle sections of baskets. You can place spoons among the other cutlery sets in order to prevent them from sticking to one another, use the cutlery grid in order to obtain the best result.

To avoid any possible injuries, always place long-handle and sharp-pointed dishes such as serving fork or bread knife with their sharp points facing down or horizontally on the baskets.



### CAUTION

Place your dishes into your machine in a way that they will not prevent the upper and lower spray arms from spinning.

### Top basket cup rack

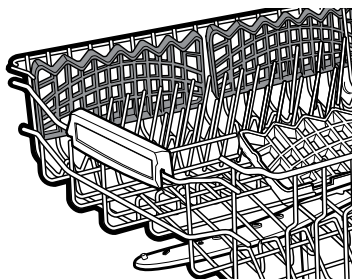

### Height Adjustable Rack

These racks are designed to increase the capacity of the top basket. You can place your glasses and cups on the racks. You can adjust the height of these racks. Thanks to this feature, you can place different sizes of glasses under these racks.

Thanks to height adjustment plastics mounted on the basket, you can use your racks in two different heights. In addition, you can place long forks, knives and spoons on these racks laterally, so that they do not block the revolution of propeller.

### Top basket height adjustment while full

Basket height adjustment mechanism on the top basket of your machine is designed to let you adjust the height of your top basket (refer to diagram ①) upwards or (refer to diagram ②) downwards, without removing it from your machine when it is full, and create large spaces at the top or bottom area of your machine as needed. Basket of your machine is set to upper position in factory settings.

In order to raise your basket, hold it from both sides and pull it upwards. In order to lower it, hold it from both sides again, pull upwards and lower carefully.

Make sure that both sides are in the same position (up or down).

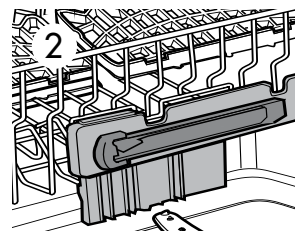
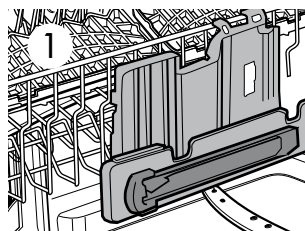
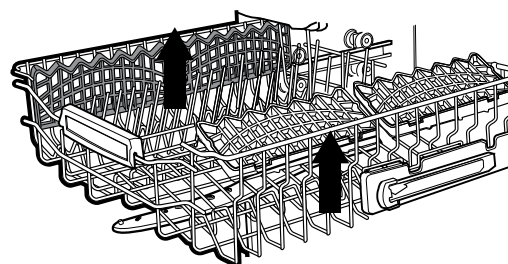

# LOADING YOUR DISHWASHER

## Spoon rack/Glass support

It allows your long-stemmed glasses to be washed safely as well as providing a convenient alternative location to wash spoons and forks. Do not lean your long-stemmed goblets and glasses against each other but towards the spoon rack, so that during the washing cycle this prevents glasses and goblets from being damaged.

There are 4 different positions for your spoon rack. Depending on the type of long stemmed glasses, you can set your spoon rack to the positions number 1 and 2.

Use it for your spoons and forks while it was in position 1.

If you do not want to use the spoon rack positions 3 or 4 are available.

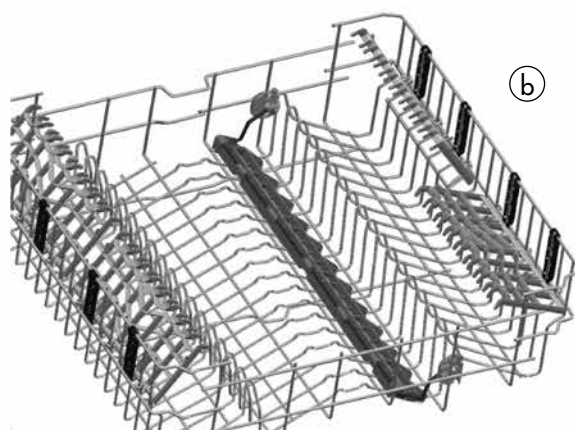
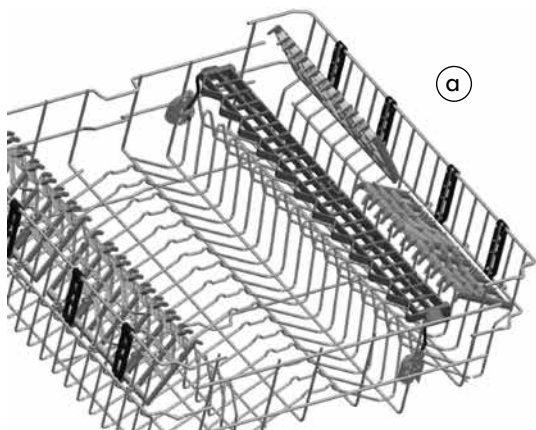
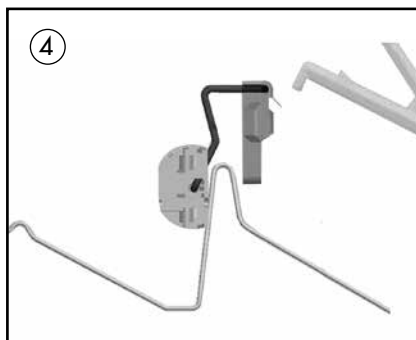
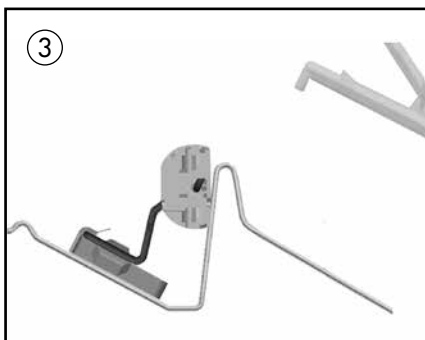
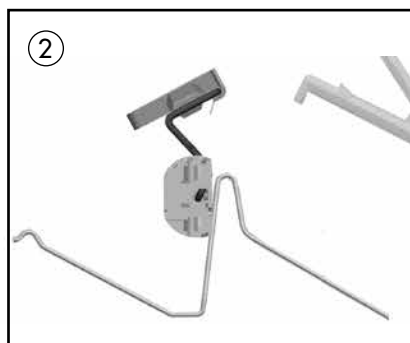
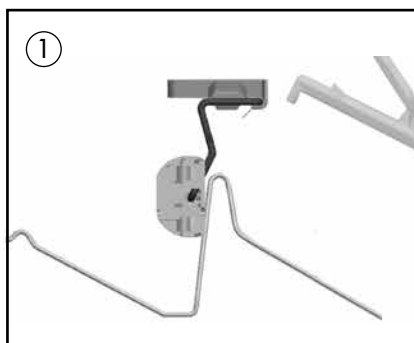
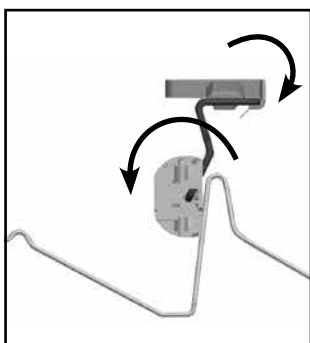
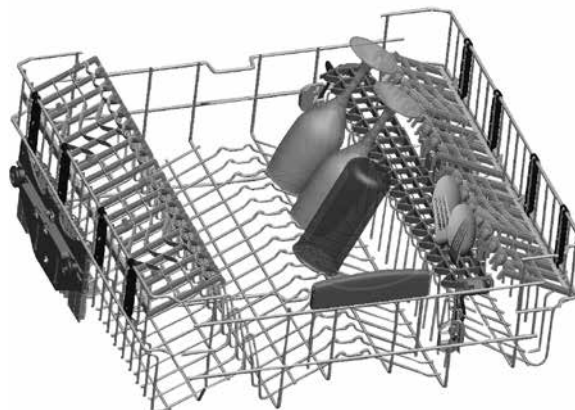



## LOADING YOUR DISHWASHER

### Lower Basket Folding Racks

Folding tines (prongs) consisting of four parts that are located on the lower basket of your machine are designed in order to let you place big items easier such as pots, pans, etc. If required, each rack can be folded separately, or all of them can be folded and larger spaces created. You can use folding tines (prongs) in the upright position, or by folding.

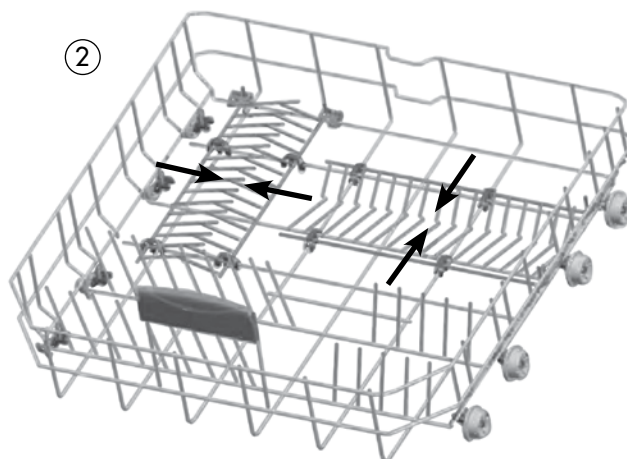
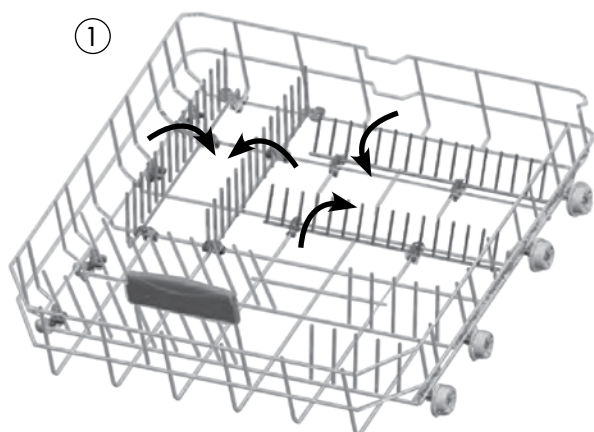

### Modular cutlery basket

Depending upon the amount of soiled cutlery, the basket can be separated into two parts. Hold the basket from both sides and move each side in opposite directions. To combine the baskets reverse the procedure.

The cutlery basket handles are adjustable, position (a) or (b). When separated, the baskets can be used in the upper or lower dishwasher basket as required.

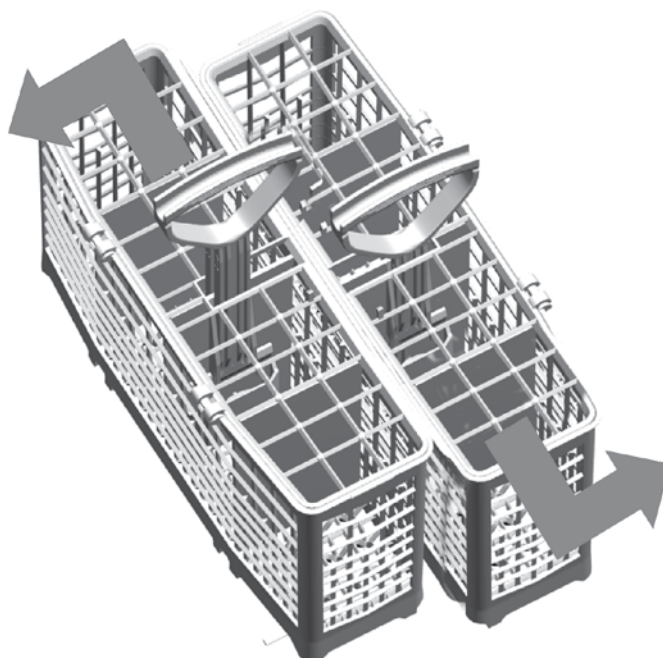
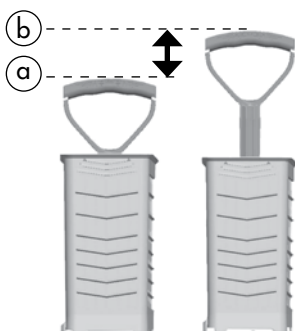

## LOADING YOUR DISHWASHER

### Alternative cutlery basket positions

The cutlery basket handle is adjustable - position (a) or (b). The basket can be used in the upper or lower dishwasher basket as required.

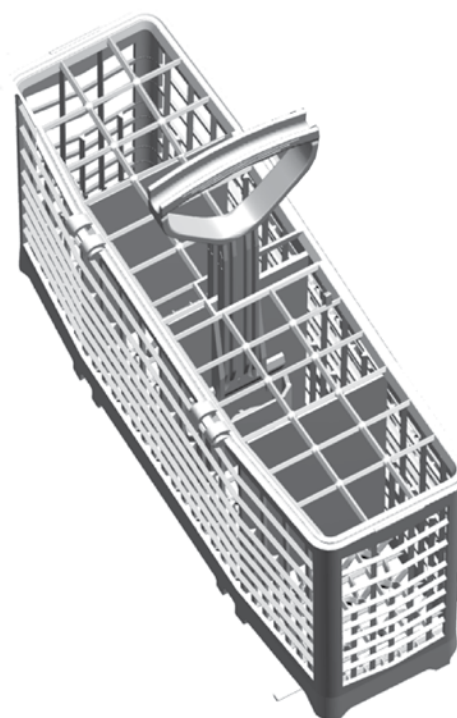
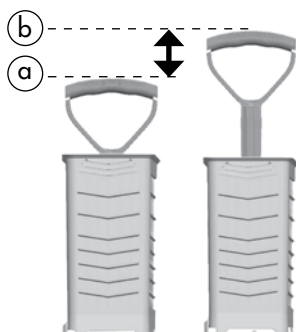

By placing your modular cutlery basket in different places of the upper or lower basket, you can create suitable locations for your other dishes.

Below you can see several recommended options.

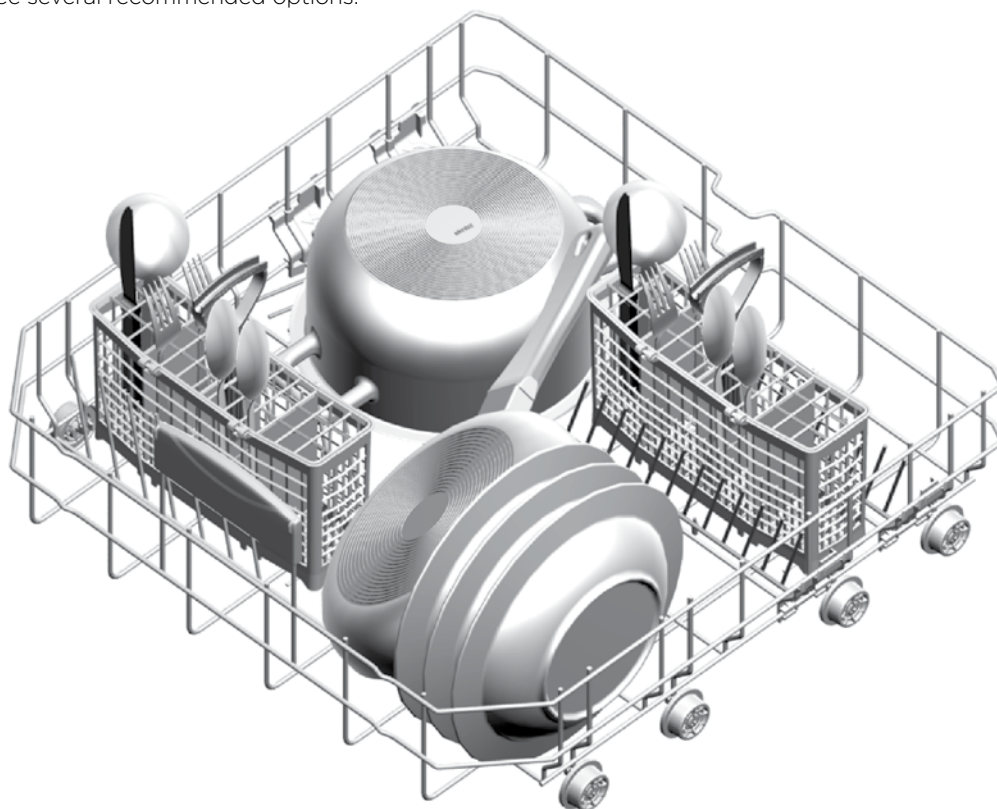

## LOADING YOUR DISHWASHER

### Alternative modular basket position

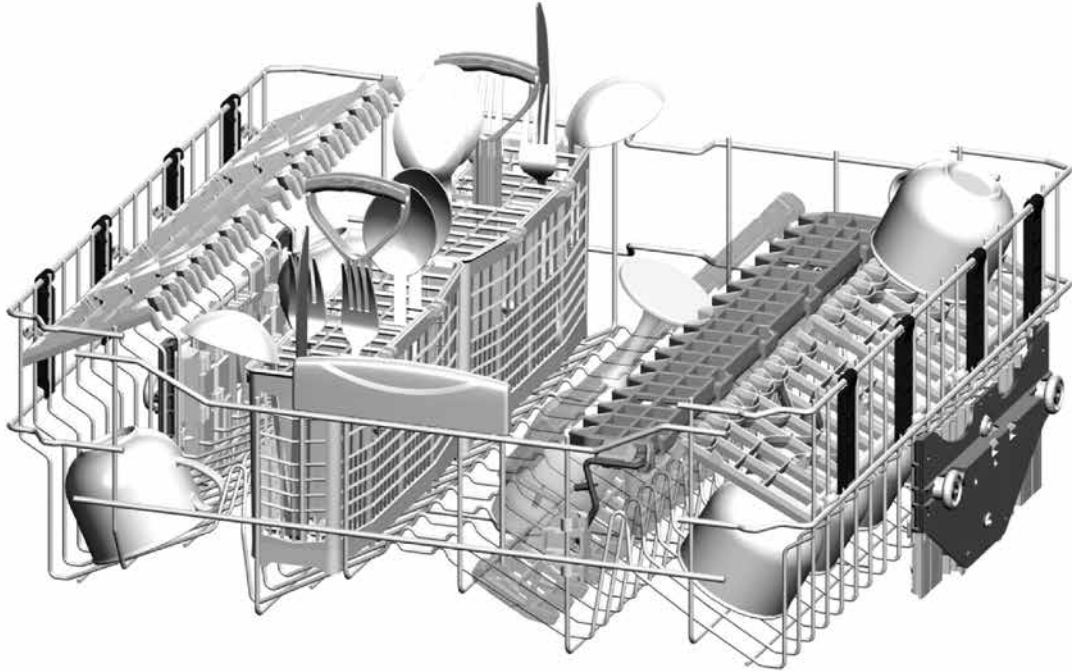

### Alternative basket loads Lower Basket

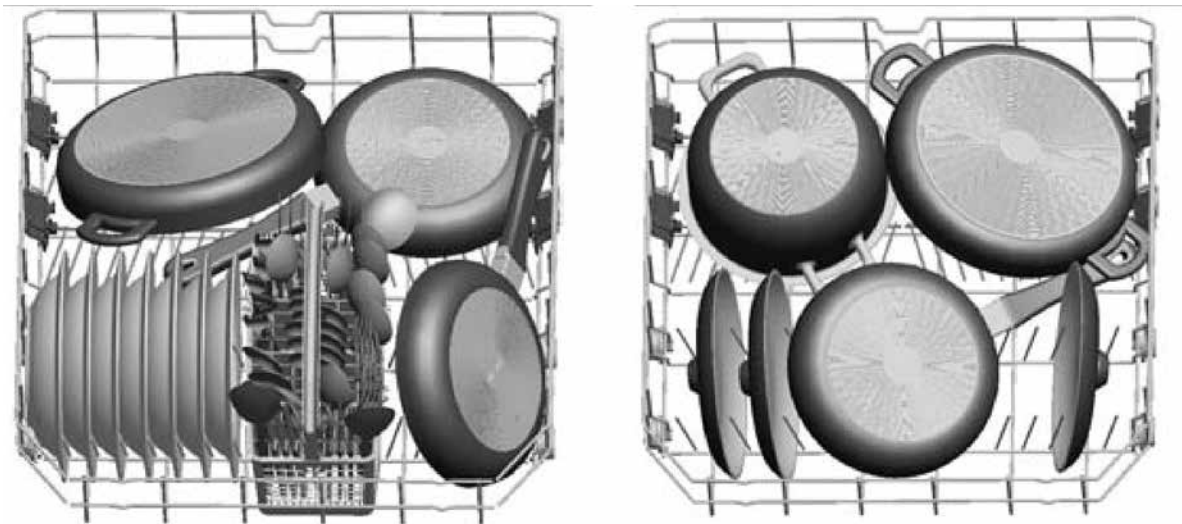

## MAINTENANCE AND CLEANING



### IMPORTANT

Cleaning the machine in regular intervals prolongs the machine's service life.

### Oil and lime may accumulate in the machine's washing section. In case of such accumulation;

- Fill the detergent compartment without loading any dishes into the machine, select a program that runs at high temperature, and start the machine. In case of insufficiency, use special cleansing material available in the market. (Cleansing material produced special to machines by detergent producers.)

### Cleaning the seals in the machine door

- To clean any accumulated residues in the door seals, wipe the seals regularly by using a dampened cloth.

### Cleaning the machine

- Clean the filters and spray arms at least once a week.
- Unplug your machine and turn off its tap before starting the cleaning.
- Do not use hard materials when cleaning your machine. Wipe with a fine cleaning material and a dampened cloth.

### Filters

- Check if any food wastes have remained on the coarse and fine filters.
- If any food wastes are left, remove the filters and clean them thoroughly under the water tap.

- a** Micro Filter
- b** Coarse Filter
- c** Metal/Plastic Filter

To remove and clean the filter combination, turn it counter clockwise and take it out by lifting upwards. **1**

Pull and remove the metal/plastic filter. **3**

Then pull the coarse filter out of the micro filter. **2**  
Rinse it with lots of water under the tap. Refit the metal/plastic filter. Insert the coarse filter into the micro filter in away that the marks will correspond to one another. Attach micro filter into the metal/plastic filter and turn to the direction of arrow and it is locked when the arrow on micro filter can be seen from across. **4**

- Never use your dishwasher without any filter.
- Incorrect fitting of the filter will reduce the washing effectiveness.
- Clean filters are very important in terms of the proper running of the machine.

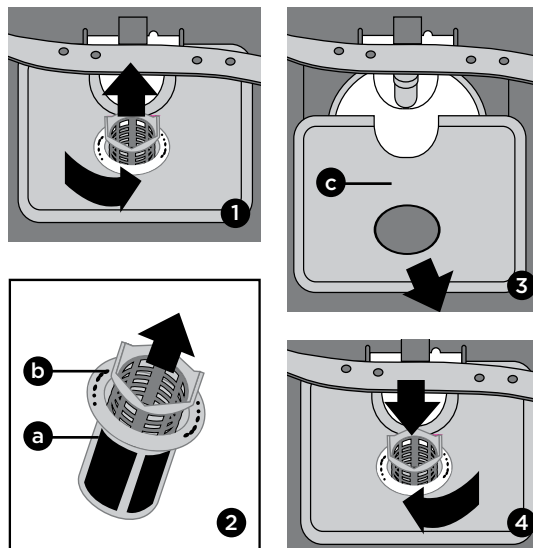

### Spray arms

Check whether or not the holes for the upper and lower spray arms are clogged. If there is any clogging, remove the spray arms and clean them under water.

You can remove the lower spray arm by pulling it upwards, while the upper spray arm nut can be removed by turning the nut to the left.

Be sure that the nut is perfectly tightened when refitting the upper spray arm.

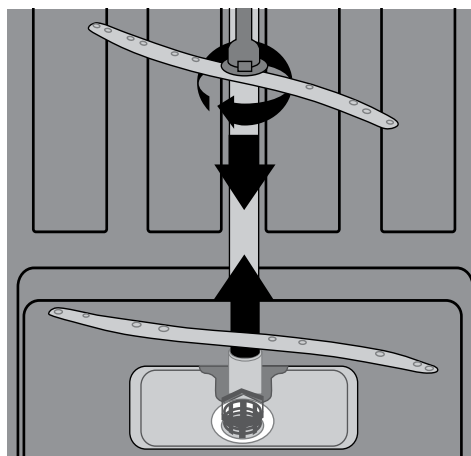

### Hose filter

Water is stopped by the inlet hose filter to avoid any damage to your machine because of any contamination (sand, clay, rust etc.) that might be occasionally carried in through the mains water supply or the indoor plumbing, and to forestall such issues as yellowing and formation of deposits after washing. Check the filter and the hose from time to time and clean them if necessary.

To clean the filter, first turn off your tap and then remove the hose. After removing the filter from the hose, clean it under the tap. Insert the cleaned filter back into its place inside the hose. Refit the hose.

## TROUBLESHOOTING

ERROR CODE	ERROR DESCRIPTION	CONTROL
F1	Overfill	<ul style="list-style-type: none"> <li>• Power off your machine and close the tap.</li> <li>• Contact the customer service centre.</li> </ul>
F2	Not draining.	<ul style="list-style-type: none"> <li>• Water discharge hose is clogged.</li> <li>• The filters of your machine might be clogged.</li> <li>• Power off-on your machine and activate the program cancellation command.</li> <li>• If the error continues, contact the Customer Care Centre.</li> </ul>
F3	Inlet valve faulty	<ul style="list-style-type: none"> <li>• Close the tap.</li> <li>• Contact the Customer Care Centre.</li> </ul>
F5	Inadequate water supply	<ul style="list-style-type: none"> <li>• Make sure the water tap is fully open and that there is mains water available.</li> <li>• Close the water tap, disconnect the hose from the tap and clean the filter at the connection end of the hose.</li> <li>• Restart your machine, contact the service if the error resumes.</li> </ul>
F6	Faulty heater sensor	Contact the Customer Care Centre.
F7	Over temperature	Contact the Customer Care Centre.
F8	Heating error	Contact the Customer Care Centre.
F9	Divertor valve faulty	Contact the Customer Care Centre.
FE	Power supply problem	Contact the Customer Care Centre.



**This document sets out the terms and conditions of the product warranties for Westinghouse Appliances. It is an important document. Please keep it with your proof of purchase documents in a safe place for future reference should there be a manufacturing defect in your Appliance. This warranty is in addition to other rights you may have under the Australian Consumer Law.**

**1. In this warranty:**

- (a) 'ACL' or 'Australian Consumer Law' means Schedule 2 to the Competition and Consumer Act 2010;
- (b) 'Appliance' means any Electrolux product purchased by you and accompanied by this document;
- (c) 'ASC' means Electrolux's authorised serviced centres;
- (d) 'Westinghouse' is the brand controlled by Electrolux Home Products Pty Ltd of 163 O'Riordan Street, Mascot NSW 2020, ABN 51 004 762 341 in respect of Appliances purchased in Australia and Electrolux (NZ) Limited (collectively "Electrolux") of 3-5 Niall Burgess Road, Mount Wellington, in respect of Appliances purchased in New Zealand;
- (e) 'Warranty Period' means the period specified in clause 3 of this warranty;
- (f) 'you' means the purchaser of the Appliance not having purchased the Appliance for re-sale, and 'your' has a corresponding meaning.

**2. Application:** This warranty only applies to new Appliances, purchased and used in Australia or New Zealand and is in addition to (and does not exclude, restrict, or modify in any way) other rights and remedies under a law to which the Appliances or services relate, including any non-excludable statutory guarantees in Australia and New Zealand.

**3. Warranty Period:** Subject to these terms and conditions, this warranty continues for in Australia for a period of 24 months and in New Zealand for a period of 24 months, following the date of original purchase of the Appliance.

**4. Repair or replace warranty:** During the Warranty Period, Electrolux or its ASC will, at no extra charge if your Appliance is readily accessible for service, without special equipment and subject to these terms and conditions, repair or replace any parts which it considers to be defective. Electrolux may, in its absolute discretion, choose whether the remedy offered for a valid warranty claim is repair or replacement. Electrolux or its ASC may use refurbished parts to repair your Appliance. You agree that any replaced Appliances or parts become the property of Electrolux.

**5. Travel and transportation costs:** Subject to clause 7, Electrolux will bear the reasonable cost of transportation, travel and delivery of the Appliance to and from Electrolux or its ASC. Travel and transportation will be arranged by Electrolux as part of any valid warranty claim.

**6. Proof of purchase** is required before you can make a claim under this warranty.

**7. Exclusions:** You may not make a claim under this warranty unless the defect claimed is due to faulty or defective parts or workmanship. This warranty does not cover:

- (a) light globes, batteries, filters or similar perishable parts;
- (b) parts and Appliances not supplied by Electrolux;
- (c) cosmetic damage which does not affect the operation of the Appliance;

- (d) damage to the Appliance caused by:
  - (i) negligence or accident;
  - (ii) misuse or abuse, including failure to properly maintain or service;
  - (iii) improper, negligent or faulty servicing or repair works done by anyone other than an Electrolux authorised repairer or ASC;
  - (iv) normal wear and tear;
  - (v) power surges, electrical storm damage or incorrect power supply;
  - (vi) incomplete or improper installation;
  - (vii) incorrect, improper or inappropriate operation;
  - (viii) insect or vermin infestation;
  - (ix) failure to comply with any additional instructions supplied with the Appliance;

In addition, Electrolux is not liable under this warranty if:

- (a) the Appliance has been, or Electrolux reasonably believes that the Appliance has been, used for purposes other than those for which the Appliance was intended, including where the Appliance has been used for any non-domestic purpose;
- (b) the Appliance is modified without authority from Electrolux in writing;
- (c) the Appliance's serial number or warranty seal has been removed or defaced

**8. How to claim under this warranty:** To enquire about claiming under this warranty, please follow these steps:

- (a) carefully check the operating instructions, user manual and the terms of this warranty;
- (b) have the model and serial number of the Appliance available;
- (c) have the proof of purchase (e.g. an invoice) available;
- (d) telephone the numbers shown below.

**9. Australia:** For Appliances and services provided by Electrolux in Australia: Electrolux goods come with guarantees that cannot be excluded under the Australian Consumer Law. You are entitled to a replacement or refund for a major failure and for compensation for any other reasonably foreseeable loss or damage. You are also entitled to have the Appliance repaired or replaced if the Appliance fails to be of acceptable quality and the failure does not amount to a major failure. 'Acceptable quality' and 'major failure' have the same meaning as referred to in the ACL.

**10. New Zealand:** For Appliances and services provided by Electrolux in New Zealand, the Appliances come with a guarantee by Electrolux pursuant to the provisions of the Consumer Guarantees Act, the Sale of Goods Act and the Fair Trading Act. Where the Appliance was purchased in New Zealand for commercial purposes the Consumer Guarantee Act does not apply.

**11. Confidentiality:** You accept that if you make a warranty claim, Electrolux and its agents including ASC may exchange information in relation to you to enable Electrolux to meet its obligations under this warranty.

**Important Notice**

Before calling for service, please ensure that the steps listed in clause 8 above have been followed.

<p><b>FOR SERVICE</b> or to find the address of your nearest authorised service centre in Australia <b>PLEASE CALL 13 13 49</b> For the cost of a local call (Australia only)</p>	<p><b>AUSTRALIA</b> ELECTROLUX HOME PRODUCTS 163 O'Riordan Street, Mascot NSW 2020 electrolux.com.au</p>	<p><b>FOR SPARE PARTS</b> or to find the address of your nearest spare parts centre in Australia <b>PLEASE 13 13 50</b> For the cost of a local call (Australia only)</p>
<p><b>FOR SERVICE</b> or to find the address of your nearest authorised service centre in New Zealand <b>PLEASE CALL 0800 10 66 10</b> (New Zealand only)</p>	<p><b>NEW ZEALAND</b> ELECTROLUX (NZ) Limited 3-5 Niall Burgess Road, Mount Wellington electrolux.co.nz</p>	<p><b>FOR SPARE PARTS</b> or to find the address of your nearest spare parts centre in New Zealand <b>PLEASE 0800 10 66 20</b> (New Zealand only)</p>

**For more information on all Westinghouse appliances, or for dimension and installation information, call into your retailer, phone or email our customer care team or visit our website:**

#### **AUSTRALIA**

phone: 1300 363 640

fax: 1800 350 067

email: [customercare@electrolux.com.au](mailto:customercare@electrolux.com.au)

web: [westinghouse.com.au](http://westinghouse.com.au)

#### **NEW ZEALAND**

phone: 0800 436 245

fax: 0800 225 088

email: [customercare@electrolux.co.nz](mailto:customercare@electrolux.co.nz)

web: [westinghouse.co.nz](http://westinghouse.co.nz)

#### **TOP SERVICE**

Top Service encompasses the after sales service provided by The Electrolux Group to consumers including delivery, home service and spare parts.

**For more information on all Westinghouse appliances, or for dimension and installation information, call into your retailer, phone or email our customer care team or visit our website:**

#### **AUSTRALIA**

phone: 1300 363 640  
fax: 1800 350 067  
email: [customercare@electrolux.com.au](mailto:customercare@electrolux.com.au)  
web: [westinghouse.com.au](http://westinghouse.com.au)

#### **NEW ZEALAND**

phone: 0800 436 245  
fax: 0800 225 088  
email: [customercare@electrolux.co.nz](mailto:customercare@electrolux.co.nz)  
web: [westinghouse.co.nz](http://westinghouse.co.nz)

#### **TOP SERVICE**

Top Service encompasses the after sales service provided by The Electrolux Group to consumers including delivery, home service and spare parts.